

de	Originalbetriebsanleitung	11
en	Original instructions	19
fr	Notice d'utilisation d'origine	29
es	Manual de instrucciones original	38
bg	Оригинална инструкция за експлоатация	47
cs	Původní návod k obsluze	55
da	Original brugsanvisning	63
et	Originaalkasutusjuhend	70
fi	Alkuperäiset käyttöohjeet	77
hu	Eredeti használati utasítás	84
it	Istruzioni d'esercizio originali	92
lt	Originali naudojimo instrukcija	100
lv	Originālā lietošanas pamācība	107
nb	Original bruksanvisning	115
nl	Originele gebruiksaanwijzing	123
pl	Oryginalna instrukcja obsługi	131
pt	Manual de instruções original	139

ro	Manualul de utilizare original	147
ru	Оригинальное руководство по эксплуатации	155
sk	Originálny návod na obsluhu	163
sv	Originalbruksanvisning	171



1

1-5

1-4

1-3

1-2

1-1

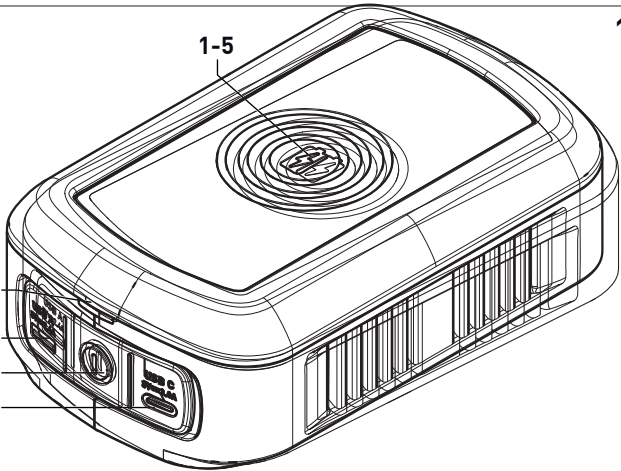

2A

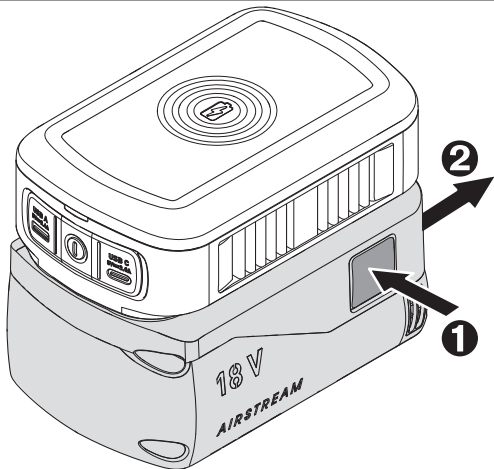

2B

klick

1

18V
AIRSTREAM

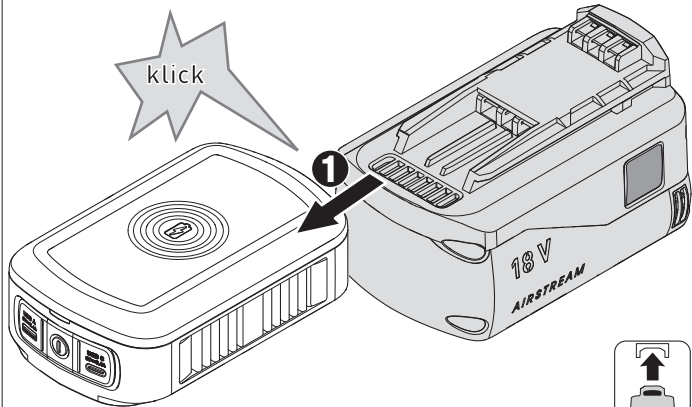

1 Symbols



Warning of general danger



Read the operating manual and safety warnings.



Inserting the battery pack.



Remove the battery pack.



CE marking: Confirms the machine's compliance with European Community directives.



UKCA marking: The United Kingdom Conformity Assessed symbol is a marking for products being placed on

the market in the United Kingdom. It is a manufacturer's indication that the product is in conformance with the relevant regulations in the UK.



Do not dispose of it with domestic waste.



Tip or advice



Handling instruction

A

Ampere

V

Volt

W

Watt

2 Safety warnings



WARNING! Read all safety warnings, instructions, illustrations and specifications

provided with this power tool. Failure to follow all instructions listed below may result in electric shock, fire and/or serious injury.

Save all warnings and instructions for future reference.

Follow the operating manual for the battery pack.

- **Do not use the machine in the rain or in damp surroundings.** Moisture in the machine may cause a short circuit and fire.
- **Do not insert any nails, wire or similar into the USB port.** This could cause the tool to short-circuit, smoke or catch fire.
- **Do not connect the electrical outlet module, an alternative power source**

or a high-voltage tool to the USB ports. To do so would be a fire risk. The USB ports are designed solely for charging low-voltage tools (USB-A port = 5 V/2.4 A; output compatible with USB-C™ = 5 V/3.0 A).

3 Intended use

The Phone charger is intended for charging mobile end devices with the customer's own USB cable or for inductive charging of smartphones.

The Phone charger is suitable for use with BP Festool battery packs of the same voltage class.



The user is liable for improper or non-intended use.

4 Technical data

Phone charger	PHC 18
USB-A port	5 V/2.4 A (12 W/port)
Output compatible with USB-C™	5 V/3.0 A (15 W/port)
Inductive charging:	
Qi-BPP / Qi-PPDE	5 W/9 W
Operating temperature	-10 °C to 50 °C (14 °F to 122 °F)
Dimension (L x W x H)	125 mm x 77.4 mm x 39 mm (4.9" x 3.0" x 1.5")

5 Parts of the device / Functional description

- [1-1] Output compatible with USB-C™
- [1-2] On/off switch
- [1-3] USB-A output
- [1-4] LED display
- [1-5] Inductive charging surface

The specified illustrations appear at the beginning of the Operating Instructions.

6 Battery pack

Before using the battery pack, check that the battery interface is clean. Any contamination of the battery interface may impair correct contact and lead to the contacts being damaged.

A faulty contact may result in the machine overheating or being damaged.

[2A]

Remove the battery pack.

[2B]



Insert the battery pack – until it clicks into place.



Further information about the battery pack with capacity indicator can be found in the corresponding operating manual.

7 Operation

7.1 Switching on/off

Switching on

- ▶ Press on/off switch [1-2].

*LED indicator [1-4] lights up green:
Phone charger is in standby.*

or

*LED indicator [1-4] flashes green for
two seconds: Battery capacity low,
Phone charger switches off automati-
cally.*

Switching off

- ▶ Press and hold the on/off switch [1-2] for two seconds.
Phone charger switches off.

 If no port is active and the Phone charger is in standby for 30 minutes, the Phone charger automatically switches off.

7.2 Charging

Inductive charging

- ▶ Place smartphone in the centre of the inductive charging surface [1-5].
- ▶ Check state of charge of the smartphone.

*LED indicator [1-4] lights up green:
Charging process begins automatically
or charging process is completed.*

-  If the smartphone does not start the inductive charging process automatically:
 - ▶ Remove the protective cover of the smartphone if necessary.
 - ▶ Place the smartphone with its reverse in the centre of the inductive charging surface [1-5].

English

- ▶ Make minimal alterations to the position of the smartphone until the charging process starts.

Charging with USB cable*

-  Metallic foreign objects (e.g. coins or keys) affect the charging process and must not be on the inductive charging surface **[1-5]**.
- ▶ Connect USB cable* with USB-A port **[1-3]** or with port compatible with USB-C™ **[1-1]**.
 - ▶ Connect USB cable* with end device.
 - ▶ Check state of charge of the end device.

*LED indicator **[1-4]** lights up green:
Charging process begins automatically
or charging process is completed.*

* Not included in the scope of delivery.

7.3 Troubleshooting

LED indicator [1-4] flashes red: Charging process faulty.

Charging process of the used port or the inductive charging surface is aborted.

- ▶ Switch off (see section [7.1](#)).
- ▶ Remove the battery pack (see section [6](#)).
- ▶ Check Phone charger for defects or foreign objects.
- ▶ Check USB cable*.
- ▶ Reinsert the battery pack (see section [6](#)).

- ▶ Switch on (see section 7.1).
- ▶ Carry out charging process again with a different end device.

If no end device can be charged, contact the manufacturer or service workshop (see section 8).

* Not included in the scope of delivery.

LED indicator [1-4] lights up red: Excessive temperature.

Charging process is interrupted.

Charging process is continued as soon as the temperature is once again low enough: LED indicator [1-4] lights up green.

8 Service and maintenance



WARNING

Any maintenance or repair work that requires opening of the motor or gear housing should only be carried out by an authorised Customer Service Centre (name supplied by your dealer)!

- ▶ Maintenance or repair work carried out by an unauthorised person can lead to the wrong connection of the power cord or other components, which in turn can lead to accidents with serious consequences.



WARNING

To prevent accidents, always remove the plug from the power supply socket before carrying out any changes or maintenance work on the tool!

- ▶ Do not use compressed air to clean the electrical tool! Do not try to clean parts inside the tool in this way, as you could let foreign objects in through the openings of the tool housing.



Customer service and repairs must only be carried out by the manufacturer or service workshops. Find the

nearest address at: www.festool.com/service



Always use original Festool spare parts. Order no. at: www.festool.com/service

- ▶ Clean the machine with a soft, dry cloth to prevent damage. Do not use solvents.

9 Environment



Do not dispose of the device in the household waste! Recycle devices, accessories and packaging. Observe applicable national

regulations.

EU only: In accordance with the European Directive on waste electrical and electronic equipment and implementa-

tion in national law, used power tools must be collected separately and handed in for environmentally friendly recycling.

Information on REACH:

www.festool.com/reach

10 General information

10.1 USA: Federal Communications Commission (FCC) Interference Statement

NOTE: This equipment has been tested and found to comply with the limits for a Class B digital device, pursuant to part 15 of the **FCC Rules**. These limits are designed to provide reasonable protection against harmful interference in a residential installation. This equip-

ment generates, uses and can radiate radio frequency energy and, if not installed and used in accordance with the instructions, may cause harmful interference to radio communications. However, there is no guarantee that interference will not occur in a particular installation. If this equipment does cause harmful interference to radio or television reception, which can be determined by turning the equipment off and on, the user is encouraged to try to correct the interference by one or more of the following measures:

- Reorient or relocate the receiving antenna.
- Increase the separation between the equipment and receiver.

English

- Connect the equipment into an outlet on a circuit different from that to which the receiver is connected.
- Consult the dealer or an experienced radio/TV technician for help.

NOTE: Any changes or modifications not expressly approved by the party responsible for compliance could void the user's authority to operate the equipment.

10.2 Imported into the UK by

Festool UK Ltd
1 Anglo Saxon Way
Bury St Edmunds
IP30 9XH
Great Britain