

Operating Instructions

— Battery-operated pressure sprayer

— AD SG 15



Imprint

Product Identification

Battery-operated pressure sprayer	Item number
ADSG 15	7350000

Manufacturer

Stürmer Maschinen GmbH
 Dr.-Robert-Pfleger-Str. 26
 D-96103 Hallstadt

Fax: 0049 (0) 951 96555 - 55
 E-Mail: info@cleancraft.de

Internet: www.cleancraft.de

Indications regarding the Operating Instructions

Original Instruction

Edition: 12.08.2022
 Version: 1.04
 Language: English
 Author: RL

Copyright

Copyright © 2022 Stürmer Maschinen GmbH, Hallstadt, Germany.

Subject to technical modifications and error.

Contents

1 Introduction	3
1.1 Copyright	3
1.2 Customer service	3
1.3 Limitation of liability	3
2 Safety	3
2.1 Symbol explanation	4
2.2 Obligations of the operating company	4
2.3 Requirements to staff	5
2.4 Personal protective equipment	5
2.5 General safety regulations	6
2.6 Safety data sheets	9
2.7 Safety signs on the device	9
3 Intended Use	10
3.1 Reasonably foreseeable Misuse	10
3.2 Residual risks	10
4 Technical Data	11
4.1 Table	11
4.2 Type plate	11
5 Transport, Packaging, Storage	11
5.1 Delivery and transport	11
5.2 Packaging	11
5.3 Storage	11
6 Description	12
6.1 Scope of delivery	12
7 Accessories	12
8 Installation	12
8.1 Assembly	12
8.2 Electrical connection	14
9 Operation	14
10 Clean, Maintenance, Repair	15
10.1 Care by cleaning	15
10.2 Maintenance and repair	16
11 Disposal/Recycling of old devices	16
11.1 Decommission	16
11.2 Disposal of electrical devices	16
11.3 Disposal via municipal collection points	16
12 Spare Parts	17
12.1 Ordering spare parts	17
12.2 Spare parts drawing	18
13 Electrical wiring diagram	20
14 EC Declaration of Conformity	21

1 Introduction

You have made a good choice by purchasing the CLEANCRAFT battery-powered pressure sprayer.

Read the operating instructions carefully before using the pressure sprayer.

These are an important part and must be kept near the battery-powered pressure sprayer and accessible to every user.

The operating instructions inform you about the proper commissioning, the intended use as well as the safe and efficient operation and maintenance of the battery-powered pressure sprayer. In addition, observe the local accident prevention regulations and general safety regulations for the area of application of the battery-powered pressure sprayer.

Illustrations in these operating instructions are for basic understanding and may differ from the actual design.

1.1 Copyright

The contents of these instructions are protected by copyright and are the sole property of Stürmer Maschinen GmbH.

Their use is permitted within the scope of using the battery-powered pressure sprayer. Any other use is not permitted without the written consent of the manufacturer.

Passing on and reproduction of this document, utilisation and communication of its contents are prohibited unless expressly permitted.

Violations will result in liability for damages.

We register trademark, patent and design rights to protect our products, insofar as this is possible in individual cases. We emphatically oppose any infringement of our intellectual property.

1.2 Customer service

Please contact your dealer if you have questions concerning your the pressure sprayer or if you need technical advice. They will help you with specialist information and expert advice.

Germany:

Stürmer Maschinen GmbH
Dr.-Robert-Pfleger-Str. 26
D-96103 Hallstadt

Repair service:

Fax: 0049 (0) 951 96555-111
E-Mail: service@stuermer-maschinen.de
Internet: www.cleancraft.de

Spare part orders:

Fax: 0049 (0) 951 96555-119
E-Mail: ersatzteile@stuermer-maschinen.de

We are always interested in valuable experience and knowledge gained from using the application-which then could be shared and be valuable to develop our products even further.

1.3 Limitation of liability

All information and notes in these operating instructions were summarised while taking applicable standards and rules, the state-of-the-art technology and our long-term knowledge and experiences into consideration.

In the following cases the manufacturer is not liable for damages:

- Non-observance of the operating instructions,
- Inappropriate use
- Use of non-professional and non-qualified personnel,
- Unauthorised modifications
- Technical changes,
- Use of not allowed spare parts.

The actual scope of delivery may deviate from the explanations and presentations described here in case of special models, when using additional ordering options or due to latest technical modifications.

The obligations agreed in the delivery contract, the general terms and conditions as well as the delivery conditions of the manufacturer and the legal regulations at the time of the conclusion of the contract are applicable.

2 Safety

This section provides an overview of all important safety packages for the protection of operating personnel as well as for safe and fault-free operation. Other task-based safety notes are included in the paragraphs of the individual phases of life.

2.1 Symbol explanation

Safety instructions

The safety notes in these operating instructions are highlighted by symbols. The safety notes are introduced by signal words which express the concern of the risk.



DANGER!

This combination of symbol and signal words indicates an imminently dangerous situation which may lead to death or severe injury if not avoided. ren Verletzungen führt, wenn sie nicht gemieden wird.

WARNING!

This combination of symbol and signal words indicates a potentially dangerous situation which may lead to death or severe injury if not avoided.

CAUTION!

This combination of symbol and signal words indicates a potentially dangerous situation which may lead to slight or minor injury if not avoided.

ATTENTION!

This combination of symbol and signal words indicates a possibly dangerous situation which may lead to property and environmental damages if they are not avoided.



NOTE!

This combination of symbol and signal words indicates a potentially dangerous situation which may lead to material or environmental damage if not avoided.



Tips and recommendations

This symbol highlights useful tips and recommendations as well as information for an efficient and trouble-free operation.

2.2 Obligations of the operating company

The operating company is the person who operates the the pressure sprayer for business or commercial reasons by herself, or leaves it to a third party for use or application, and who bears the legal product responsibility for the protection of the user, the staff or for third parties.

Obligations of the operating company

If the the pressure sprayer is used for commercial purposes, the operating company of the the pressure sprayer must comply with the legal working safety regulations.

Therefore, the safety notes in this operating manual, as well as the safety, accident prevention and environment protection regulations applying for the area of application of the the pressure sprayer must be met. The following applies in particular:

- The operating company must be informed about the applying industrial safety regulations and further analyse hazards resulting from the special working conditions at the place of use of the the pressure sprayer. She must implement these in form of operating manuals for the operation of the the pressure sprayer.
- During the entire lifetime the the pressure sprayer, the operating company must verify whether the operating manuals prepared by her correspond to the current status of the regulations, and must adapt these if necessary.
- The operating company must unambiguously regulate and determine the responsibilities for installation, operation, troubleshooting, maintenance and cleaning.
- The operating company must ensure that all persons who work with the the pressure sprayer, have read and understood this manual. Furthermore she must instruct the staff in regular intervals and inform them about the hazards.
- The operator must provide the necessary protective equipment to the staff and order the use of the necessary protective equipment in a binding way.

Furthermore the operating company is responsible to keep the the pressure sprayer always in a technically flawless state. Thus, the following applies:

- The operator must ensure that the maintenance intervals described in this manual are kept.
- The operator must have all safety devices checked regularly for their good working order and their integrity.

2.3 Requirements to staff

Qualifications

The different tasks described in this manual represent different requirements to the qualification of the persons entrusted with these tasks.



WARNING!

Danger in case of insufficient qualification of the staff!

Insufficiently qualified persons cannot estimate the risks while using the the pressure sprayer and expose themselves and others to the danger of severe or lethal injuries.

- Have all works only performed by qualified persons.
- Keep insufficiently qualified persons out of the working area.

Only persons reliable working procedures can be expected from, are allowed to perform all works. Persons the responsiveness of which is affected by e. g. drugs, alcohol or medication, are not allowed to work with the machine.

The qualifications of the personnel for the different tasks are mentioned below:

Operator

The operator is instructed by the operating company about the assigned tasks and possible risks in case of improper behaviour. Any tasks which need to be performed beyond the operation in the standard mode must only be performed by the operator if it is indicated in these instructions and if the operating company expressly commissioned the operator.

Electrically qualified person

Electrically qualified person is due to their professional training, knowledge and experience as well as knowledge of the relevant standards and regulations, in a position to carry out work on the electrical systems and to independently recognize and avoid possible dangers.

Qualified personal

Due to their professional training, knowledge and experience as well as their knowledge of relevant regulations the specialist staff is able to perform the assigned tasks and to recognise and avoid any possible dangers themselves.

Manufacturer

Certain works may only be performed by specialist personnel of the manufacturer. Other personnel is not authorized to perform these works. Please contact our customer service for the execution of all arising work.

2.4 Personal protective equipment

The personal protective equipment serves to protect persons against impairments of safety and health while working. The staff member has to wear personal protective equipment while performing different tasks on and with the battery-operated pressure sprayer which are indicated in the individual paragraphs of these instructions.

The personal protective equipment is explained in the following paragraph:



Ear protection

Ear protection protects the ears from hearing damage caused by noise.



Face protection

The face mask protects the face from flying around parts.



Breathing protection

Use the breathing protection!



Protective gloves

The protective gloves serve to protect the hands against sharp components as well as against friction, abrasions or deep injuries.



Safety boots

Safety boots protect the feet from being crushed, falling parts and slipping over on slippery ground.



Protective clothes

Protective clothes are made of a tightly fitted fabric without the protruding parts of low tear strength.

2.5 General safety regulations

The following must be observed:

Wear mask, helmet, protective clothing, waterproof gloves and water resistant boots during operation.

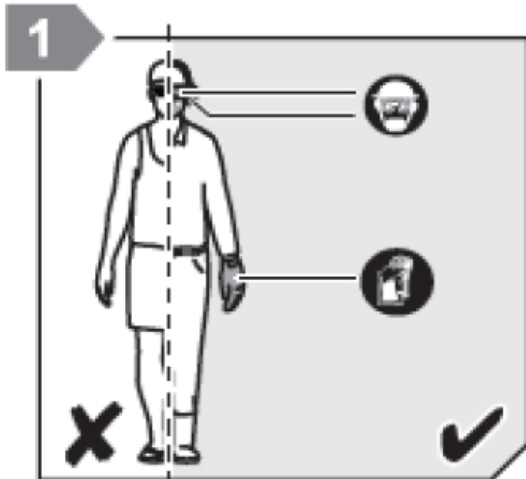

Fig. 1: Wear protective clothing

Keep the plant protection product out of the reach of children. Dispose of plant protection products in strict compliance with the pesticide manufacturer's safety instructions.

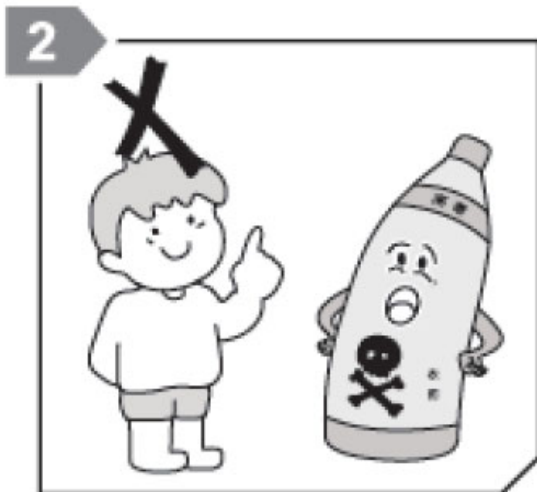

Fig. 2: Keep pesticides away from children

Take care not to inhale the toxic spray fog! Should this happen, go to a well ventilated place and lie down. If skin and mucous membranes are affected, wash the skin areas immediately with clean water. If swallowed, drink water or warm salt water to induce vomiting and consult a doctor as soon as possible.

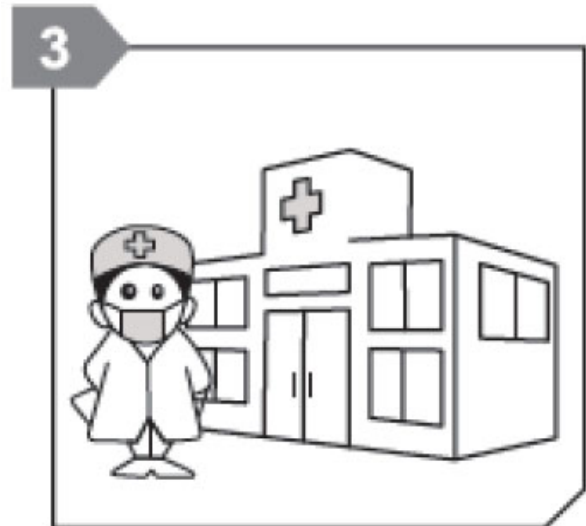

Fig. 3: Consult a doctor if inhaled spray fog

Keep the spray solution with plant protection agent in a special bottle at a secure place or dispose of the product in strict compliance with the regulations. In no case should the plant protection products simply be disposed of in the environment.

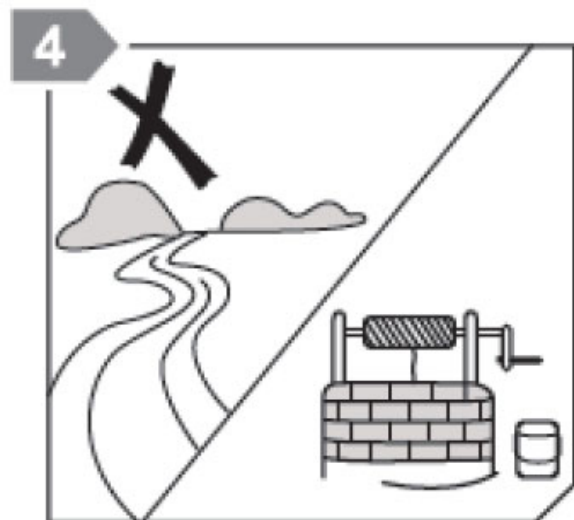

Fig. 4: Never dispose of plant protection products in nature

Avoid working with pesticides if you are pregnant or suffer from a disease, fatigue, injury or allergy.

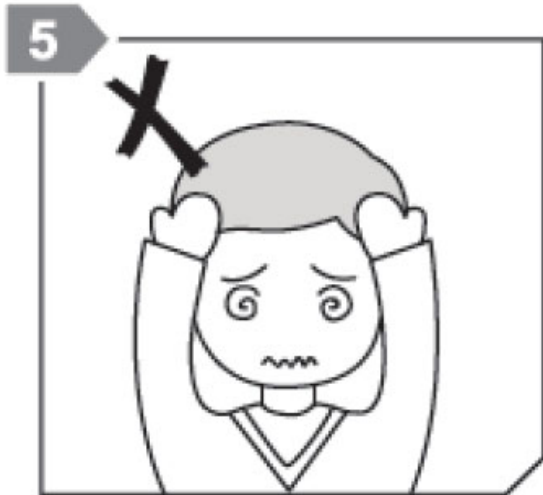

Fig. 5: Allergic reaction

To kill pests, only use plant protection products that are intended for the appliance.



DANGER!

The use of high toxic and aggressive pesticides is strictly forbidden for the application on vegetables, melons, fruit trees, tea, medicinal and cultivated plants.

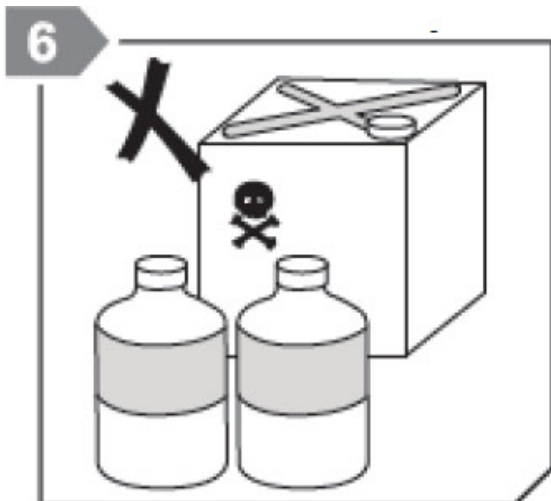

Fig. 6: Highly toxic plant protection products prohibited

Do not leave the Pressure Sprayer unattended to avoid danger to the public.

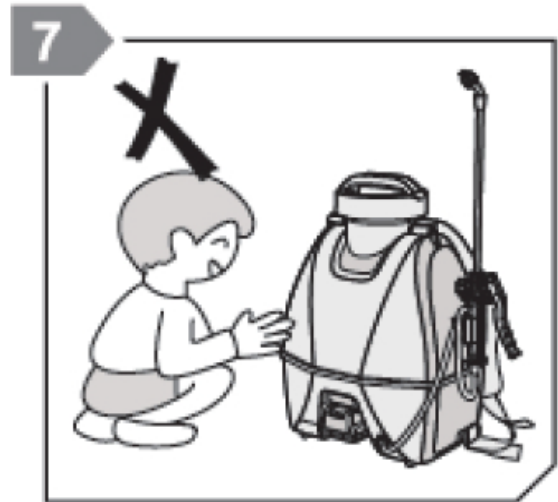

Fig. 7: Do not leave the device unattended

The battery pressure sprayer may only be used in the range of temperature from 0° C to 45° C.

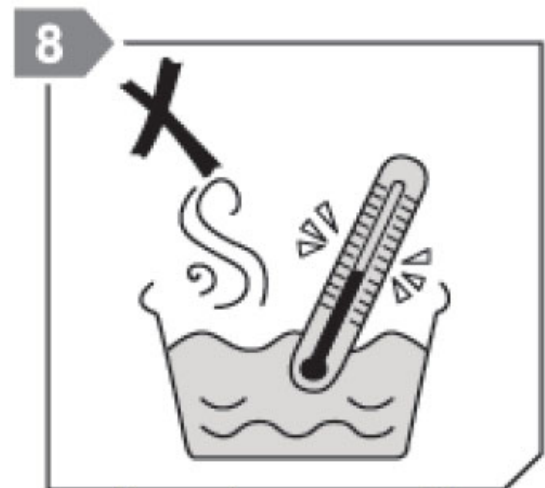

Fig. 8: Maintain operating temperature

Test the pressure sprayer with water before use to avoid any leakage and to ensure that the sprayer is intact.

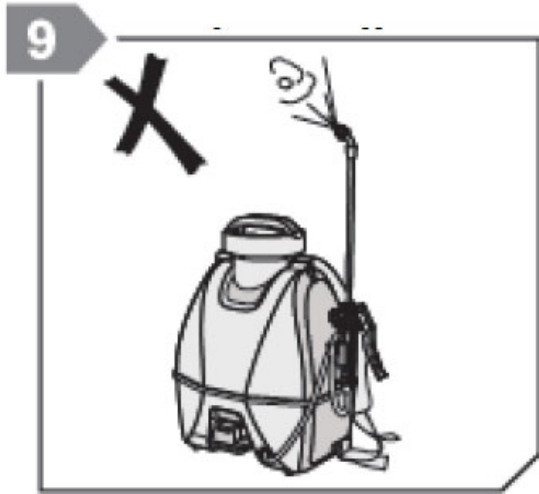

Fig. 9: Test run of the device with water only

Never spray pesticides against the wind, on people, animals or food.
Do not point the nozzle at the energized device to avoid the danger of a electric short circuit.

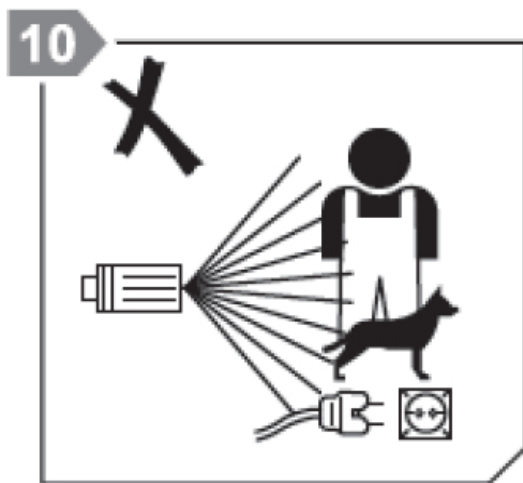

Fig. 10: Do not target at people, animals or any device.

Mix and dilute the liquid according to the instructions and recommendations of the pesticide manufacturer. Do not change the dilution ratio at will. This will prevent damage to people or plants. It is also possible that the desired application effect may not be achieved.



Fig. 11: Observe mixing ratio

Change clothes after use and wash all parts of the body thoroughly with soap and water. Take a shower if necessary.

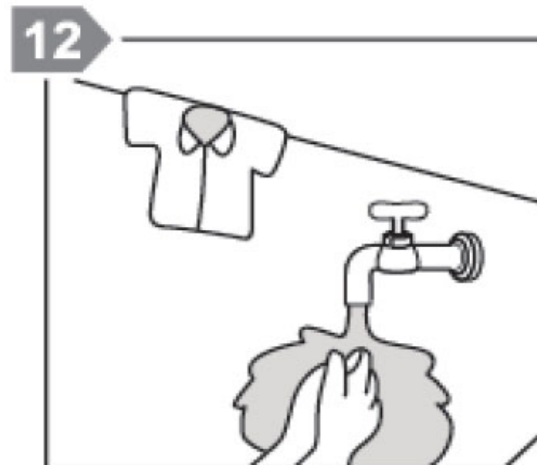

Fig. 12: Shower after application
Do not use the device for cleaning of your body or your clothing.

- Children or unqualified persons must not use the pressure sprayer.
- Do not use the device if it is damaged. If a defect in the battery or power supply unit is noticed, it must be replaced by the manufacturer or maintenance personal.
- The components used for this product, battery and power supply unit, may cause fire or burns if handled improperly. Never disassemble, short circuit, heat to more than 60°C or throw into fire. Also keep out of the reach of children.

Warnings: Battery and charger



NOTE!

The battery reaches its maximum capacity only after several charging cycles.

Do not place the battery and charger in water or moisten them.

Do not charge, use or store the battery and charger near hot areas or heat sources!

Only use original accessories which are intended for the pressure sprayer.

Do not short-circuit the positive and negative electrodes of the components with cables or other objects!

Do not damage the battery and the charger.

Never try to disassemble the battery. Do not use the battery or charger if they are damaged. A damaged battery or charger must be returned to a disposal centre.

The application must be stopped immediately if there is a smell, color or shape change. The battery must be charged and discharged every three months when not in use.

The charger and battery may only be used indoors and when charging, they should be placed in a well ventilated place.

Do not allow children or unauthorized persons to handle the battery or charger.

To disconnect the charger from the power supply, always pull on the plug, never on the cable.

Make sure the cable is placed correctly to avoid tripping over or damaging the power adapter

Do not install the charger on a wall or permanently mount it on a surface. The charger must be placed on a flat and stable surface (e.g. desk, workbench).

The charger is only intended for connection to the 220 volt mains supply.



ATTENTION!

The components used for this product, the battery and the power supply unit, can cause a fire or burns if handled improperly. Never disassemble, short-circuit, heat to more than 60°C or dispose of the battery or AC adapter in fire. Also keep out of the reach of children.

Notes on operation



ATTENTION!

The pressure jet can be dangerous if used improperly.

DO NOT direct the pressure jet at people or animals.

DO NOT direct the pressure jet at yourself or other persons to clean clothing or shoes.

DO NOT direct the pressure jet at the appliance itself, electrical components or other electrical appliances.

All live parts must be PROTECTED against the water jet.

2.6 Safety data sheets

Safety data sheets on hazardous materials can be obtained from your specialist dealer or by calling +49 (0)951/96555-0. Specialist dealers can find safety data sheets in the down-load area of the partner portal.

2.7 Safety signs on the device

Safety markings and instructions are attached to the device (Fig. 1), which must be observed and followed.



Fig. 13: Mandatory signs and warning signs

Damaged or missing safety symbols on the machine can cause incorrect handling with personal injury and material damage. The safety symbols attached to the machine must not be removed. Damaged safety symbols must be replaced immediately.

From the moment the signs are not immediately visible and comprehensible at first sight, the machine must be taken out of operation until the new signs are attached.

3 Intended Use

The pressure sprayer is used exclusively for spraying liquid, non-solvent-containing pesticides, insecticides, garden weedkillers, fertilisers, window cleaners and natural oils dissolved in water (e.g. neem oil, rapeseed oil).

The area of application includes the home, garden and greenhouses.

Intended use also includes compliance with all the information in these instructions.

3.1 Reasonably foreseeable Misuse

Any use beyond or different from the intended use is considered misuse.

Possible misuses can be:

- Use of the battery-powered pressure sprayer in rooms with aggressive, explosive or flammable substances (the pressure sprayer is not explosion-proof as standard).
- Operating the battery-powered pressure sprayer without functioning, intended protective devices.
- Using the battery-powered pressure sprayer for a long time at high temperatures.
- Bypassing or modifying the machine or its protective devices.
- Exceeding the performance limits specified in the "technical data".
- Failure to observe the maintenance instructions.
- Non-observance of signs of wear and damage.
- Service work carried out by untrained or unauthorised personnel.
- Deliberate or careless handling of the battery-powered pressure sprayer during operation.
- Installation of spare parts and use of accessories and equipment not approved by the manufacturer.
- Modifications to the battery-powered pressure sprayer or the use of modified tool systems.
- Use of the battery-powered pressure sprayer in the food and medical sectors.
- Use of the equipment with flammable, toxic liquids.
- Use of the battery-powered pressure sprayer if the operating instructions are incomplete or have not been read and understood correctly.

Misuse of the pressure sprayer can lead to dangerous situations.

In the event of design and technical modifications to the Stürmer Maschinen GmbH accepts no liability for constructive and technical changes to the battery-operated pressure sprayer.

Claims of any kind for damage due to improper use are excluded. Kind for damage due to improper use are excluded.

3.2 Residual risks

Even if all safety instructions are observed and the pressure sprayer is used according to the instructions, there are still residual risks, which are listed below:

- Risk of injury to upper limbs (e.g. hands, fingers) due to moving parts.
- Skin and respiratory tract damage in case of long-term exposure to the cleaning agent without suitable protective equipment.
- Risk of injury and damage to property due to flying parts.
- Battery: Electrical hazard through contact with parts and high voltage (direct contact) or with parts that are under a high voltage due to a defect of the device (indirect contact).

4 Technical Data

4.1 Table

Data	ADSG 15
Length (product) ca.	344 mm
Width/Depth (product) ca.	241 mm
Height (product) ca.	486 mm
Weight (net) ca.	4,3 kg
Supply voltage	18 V
Current type	DC
Working pressure	1,2 - 4,5 bar
Working pressure (max)	4,5 bar
Pump pressure	3,2 - 4,6 bar
Pump pressure (max)	6,5 bar
Delivery rate (max)	126 l/min
Working capacity	48 - 90 l/min
Inlet temperature	40 °C
Sound pressure level	63,4 dB(A)
Sound power level	75 dB(A)
Engine speed	2100 rpm
Protection class	Charger II / Device III
Engine insulation class	A
Total current consumption	0,8 A
Tank	15 Liter
High-pressure hose length	1,7 m
Battery capacity	2 Ah
Operating time	2 - 3 h
Charging time	ca. 5 h

4.2 Type plate





Akku-Drucksprüherät Battery-operated pressure sprayer		  	
Typ Type	ADSG 15	Serien-Nr. Serial no.	
Artikel-Nr. Item no.	7350000	Baujahr Year of manufacture	Monat/Jahr month/year
Nennleistung Rated power	20 W	Schallleistungspegel Sound power level	75 dB(A)
Spannung Power supply	18 V	Max. Fördermenge Max. Flow rate	126 l/h
Gewicht Weight	4,3 kg	Behältervolumen Tank capacity	15 l
		Stürmer Maschinen GmbH Dr.-Robert-Pfleger-Str. 26, 96103 Hallstadt Deutschland / Germany	

Fig. 14: Type plate

5 Transport, Packaging, Storage

5.1 Delivery and transport

Delivery

Check the battery-operated pressure sprayer for visible transport damage after delivery. If you discover any damage to the battery-operated pressure sprayer, please report this immediately to the transport company or the retailer.

Transport



ATTENTION!

Danger of injury due to objects falling over or off the forklift, pallet truck or transport vehicle.

Only use transportation equipment and load slings that can carry the total weight.

Improper transport of single devices, packed or unpacked non-secured devices that are stacked on top of each other or next to each other is liable to accidents and can cause damage or malfunctions for which we do not provide liability or guarantee.

Transport the scope of delivery secured against shifting or tilting to the place of installation with a sufficiently dimensioned industrial truck.

Transport may only be carried out by authorized and qualified persons.

5.2 Packaging

All packaging materials and packaging aids used for the Battery-operated pressure sprayer are recyclable and must always be returned for material recycling.

Shredded packaging components should be disposed of in the waste paper container.

The foils are made of polyethylene (PE) and the padded parts of polystyrene (PS). These materials can be handed in at a recycling collection depot or to your local waste disposal company.

5.3 Storage

Store the battery-operated pressure sprayer in a dry, clean and frost-free environment.

6 Description

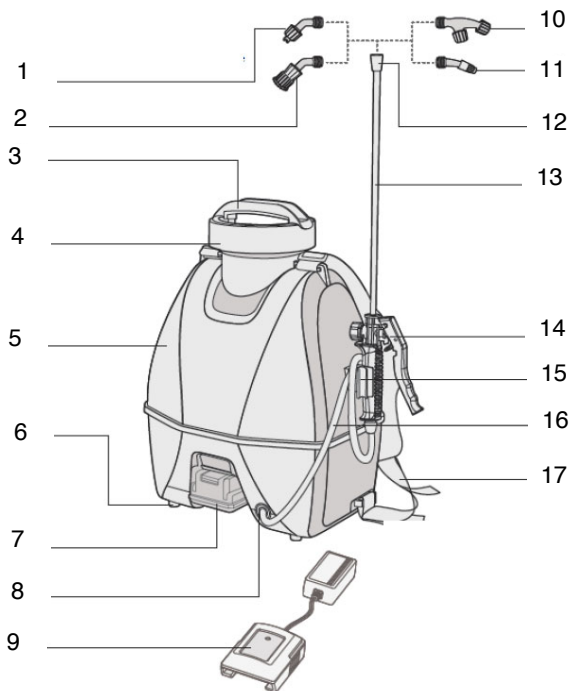

Fig. 15: Description

- 1 Blower nozzle
- 2 Shower nozzle
- 3 Carrying grip
- 4 Cover
- 5 Barrel body
- 6 Pedestals
- 7 Battery pack
- 8 Outlet
- 9 Battery charger
- 10 Double nozzle
- 11 Tapering nozzle
- 12 Outlet component
- 13 Spray tube
- 14 Spray gun switch
- 15 Spray gun holder
- 16 Discharge line
- 17 Belt installation

6.1 Scope of delivery

- Spray Gun
- Lance
- Flexible tube
- Round nozzle
- Double nozzle
- Adjustable nozzle
- Flat nozzle
- Samsung battery pack 2 Ah/18V DC
(The safety data sheet can be obtained from your specialist dealer or by calling +49 (0)951/96555-0)
- Charger 0,4 A
- Harness
- Battery pressure sprayer
- Instruction manual

7 Accessories

- Battery 18V / 4,0 Ah
Item number: 7013547
- Charger 2,0 A
Item number: 7013548
- Spray gun
Item number: 7360000
- Lance
Item number: 736001
- High pressure hose 1,7m
Item number: 7360002
- Round nozzle
Item number: 7360003
- Double nozzle
Item number: 7360004
- Adjustable nozzle
Item number: 7360005
- Flat nozzle
Item number: 7360006
- Harness
Item number: 7360007

8 Installation

8.1 Assembly



ATTENTION!

The device must be disconnected from the power supply for all installation- and assembly work.

Step 1: Remove the parts of the Battery Pressure Sprayer from the packaging and attach the belt to the Battery Pressure Sprayer (Fig.16).

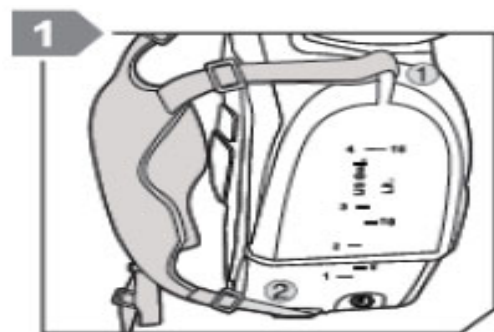

Fig. 16: Mounting the belt

Step 2: Install the gun rod on the gun handle (fig. 17).

Step 3: Install one of the four available nozzles on the gun rod (fig. 17).

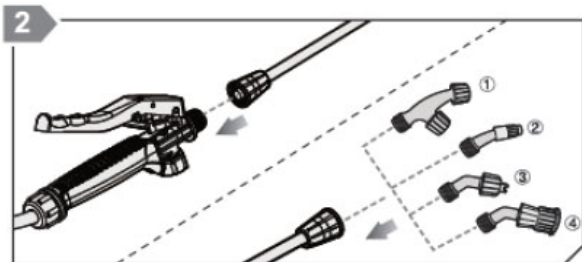

Fig. 17: Mounting the spray gun

Step 4: Remove the battery and charge it (Fig.18)

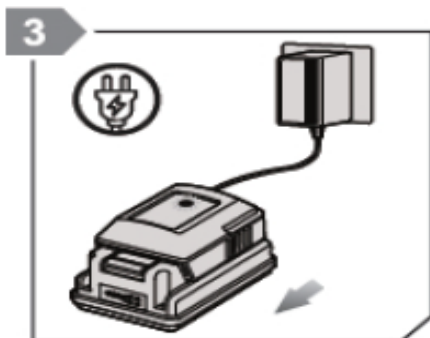

Fig. 18: Charge the battery

Step 5: Insert the full charged battery into the battery socket on the device (Fig.19).

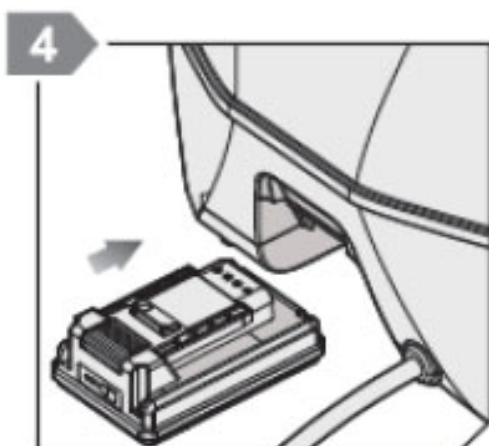

Fig. 19: Insert the battery

Step 6: Test the battery pressure sprayer at first with water before adding chemicals (Fig. 20).

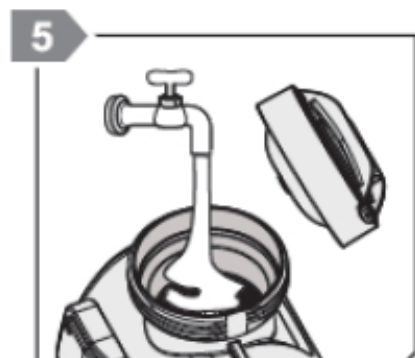

Fig. 20: Functional test with water

Step 7: Press the Power button on the device (Fig. 21).

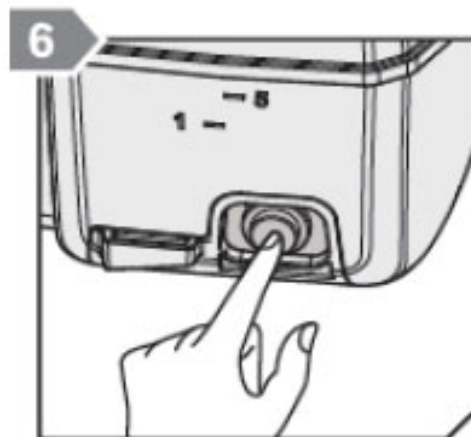

Fig. 21: Switch ON the device

Step 8: Press the trigger on the pistol grip to start the device. Press the red locking mechanism in position to keep it switched on (Fig. 22).

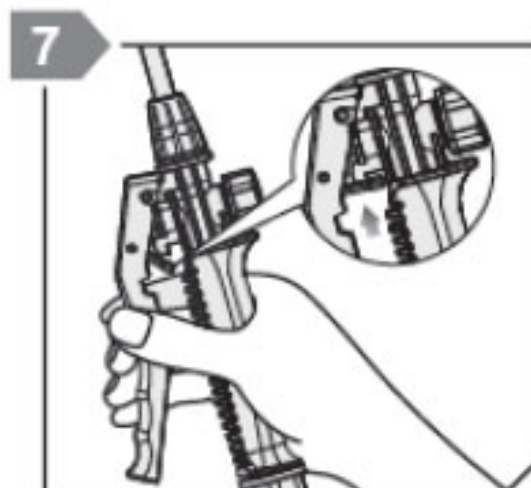

Fig. 22: Locking mechanism for continuous operation with the spray gun



Fig. 23: Spray gun with locking mechanism

8.2 Electrical connection



DANGER!

Danger due electric shock!

The pressure sprayer is operated by a rechargeable battery.

Caution when operating the charger on 220 V mains voltage.

9 Operation

- Test the battery pressure sprayer with water before using it for the first time to make sure there is no leakage or poor atomisation.
- Avoid operating the battery pressure sprayer without water as this may damage the pump.
- Do not use the battery pressure sprayer below 0 ° C.
- Do not start the unit when it is frozen. Frost damage is not covered by the warranty!
- Be sure to follow the safety instructions for pesticides.
- Make sure that the unit is secure and stable.
- Operate the unit in an upright position (Fig.24).



Fig. 24: Operating position of the device

- Do not cover the device and do not use it in poorly ventilated rooms.

To ensure the product operates at a constant temperature and to extend the working time and life of the battery, do not use it when the surface of the battery is hot.

Before Operation



ATTENTION!

Only use CLEANCRAFT batteries and chargers for this device. Damages caused by the use of other batteries or chargers are not covered by the warranty.

The battery is charged before delivery. However, it is possible that it will be automatically discharged during transport and storage.

Step 1: Charge the battery in the charger.

During operation



DANGER!

Do not operate the battery pressure sprayer at high temperatures for long periods of time.
Do not spray pesticides against the wind, on people, animals or food.
Do not direct the nozzle towards the electrical parts of the device to avoid the risk of short circuits.

Step 2: Remove the fully charged battery from the charger and put it into the pressure sprayer.

Step 3: Fill the battery pressure sprayer with the liquid.

Step 4: Hold the pistol grip firmly in both hands and be considered that spraying will cause a kickback.

Step 5: Press the trigger on the spray gun to start spraying. Activate the red lock to perform a continuous spraying operation (Fig. 22/23).

Step 6: Execute the spraying process.

Step 7: Stop the spraying process by unlocking the locking mechanism and releasing the trigger.

After Operation

Step 1: Turn off the device with the switch off button (Fig.25).



Fig. 25: switch-OFF button

Step 2: Empty the pressure sprayer completely



ATTENTION!

Many spray liquids will dry out and harden if kept in the battery pressure sprayer. This can cause a clogging of the nozzle, shut-off valve and tube.

Step 3: Clean and dry the battery pressure sprayer after use and before storage.

If you store the device, remove the battery first.

10 Clean, Maintenance, Repair



DANGER!

Risk of electric shock!

Remove the battery before servicing, cleaning or repairing the device.

Turn off the spray switch and remove the battery before servicing, cleaning and repairing the unit. Contact CLEANCRAFT for maintenance and use of original accessories.

Turn the unit off with the OFF switch when:

- Start or stopfails.
- The unit vibrates.
- Pressure fluctuations occur.
- Engine noises occur.
- Fuses blow.

Switch off the power supply immediately and contact your dealer.

The O-ring and washer are wearing parts. The frequency of replacement depends on the time of use, the sprays used and regular cleaning of the pressure sprayer. If the unit is clogged, loosen the nut on the pipe, check the pipes and clean them.

10.1 Care by cleaning

The pressure sprayer must always be kept in a clean condition.



Protective gloves

Wear suitable protective gloves for cleaning!

Do not wash the battery pressure sprayer in water.

Do not use aggressive acids, strong bases or flammable liquids for cleaning.

Disconnect the charger from the power outlet before cleaning.

10.2 Maintenance and repair



ATTENTION!

Maintenance and repair work must always be carried out by qualified personnel: To maintain the warranty, use only original parts approved by the manufacturer.

If the pressure sprayer does not work properly, contact a specialist dealer or our customer service. The contact details can be found in chapter 1.2 'Customer Service'.

Maintenance the battery

Please pay attention to the capacity of the battery. If the battery capacity is low, recharge in time. If the battery is disconnected from the mains for a long period of time, the battery will go into a resting mode.

Charge and Store the battery

To obtain longer battery life, avoid charging immediately after a full discharged battery. Let the battery cool down for a few minutes.

Safety instructions for the battery

The battery is a sealed device with no safety risk under normal conditions. Avoid contact with the battery liquid if the battery leaks. In case of contact with battery fluid, take the following precautions:

- Skin contact with the battery fluid may cause irritation. Wash with soap and water.
- Inhalation of vapors may cause respiratory irritation. Breathe fresh air and seek for medical consultation.
- In case of eye contact, the battery fluid may cause irritation. Immediately flush eyes thoroughly with water for at least 15 minutes and seek medical consultation.

Recycling the battery

Proceed as follows with the battery to be recycled:

- Do not use the battery again.
- Remove the battery from the device.
- Disconnect it from the charger.
- Do not throw the battery in the household waste
- Dispose of the battery according to local laws and regulations.

11 Disposal/Recycling of old devices

In your own interest and in the interest of the environment, please ensure that all components of the device are disposed of only through the designated and approved methods.

11.1 Decommission

Worn-out devices must be immediately taken out of service in a professional way in order to avoid later misuse and to avoid environmental or personal hazards.

- Remove all environmentally harmful operating materials from the old device.
- If necessary, dismantle the device into manageable and recyclable parts and components.
- Dispose of the device components and operating materials in the designated disposal method.

11.2 Disposal of electrical devices

Please note that electrical equipment contains a variety of recyclable materials and environmentally harmful components.

Please help to ensure that these components are separated and properly recycled. If in doubt, please contact your local waste disposal company.

You may need to seek the assistance of a specialized waste disposal service for processing.

11.3 Disposal via municipal collection points

Disposal of used and electronic equipment (Applicable in the countries of the European Union and other European countries with a separate collection point for this device).



The symbol on the product or its package indicates that this product should not be treated as normal household waste and should be disposed of at a collection point for the recycling of electronic devices. By helping to dispose of this product correctly, you will help to protect the environment and the health of people around you. Environment and health are at risk if incorrect disposal is made. Material recycling helps to reduce the consumption of resources. For more information about recycling this product, contact your local authority, municipal waste disposal service or the store where you purchased the product.

12 Spare Parts



DANGER!

Risk of injury due to use of incorrect spare parts!

The use of incorrect or faulty spare parts can lead to dangers for the operator, damage and malfunctions.

- Only original spare parts from the manufacturer or spare parts approved by the manufacturer may be used.
- Always contact the manufacturer if you are in any doubt.



NOTE!

The manufacturer's warranty expires if unauthorized spare parts are used.

12.1 Ordering spare parts

Spare parts are available from authorised retailers or directly from the manufacturer.

Contact details:

Fax: 0049 (0) 951 96555-119

E-mail: ersatzteile@stuermer-maschinen.de

Always quote the following key data with your spare parts orders:

- Device type
- Article number
- Position number
- Year of manufacture
- Quantity
- Desired shipping type (post, freight, sea, air, express)
- Shipping address

Spare parts orders without the aforementioned data cannot be taken into account. The supplier shall determine the shipping type if no relevant data was provided.

Information about the device type, article number and year of manufacture can be found on the type plate. The type plate is mounted on the device.

Example:

The pump for the battery-operated pressure sprayer has to be ordered. The pump has the number 24 in the spare parts drawing (1).

When ordering spare parts, send a copy of the spare parts drawing (1) with marked component (pump) and marked item number (24) to the authorized dealer or to the spare parts department and provide the following information:

- Type of device: **Battery-operated pressure sprayer
ADSG 15**
- Item number: **7350000**
- Drawing number: **1**
- Position number: **24**

The part number of your device:

Battery-operated pressure sprayer ADSG 15: 7350000

12.2 Spare Parts Drawing

The following drawing should help to identify the necessary spare parts in case of service.

Spare parts drawing 1

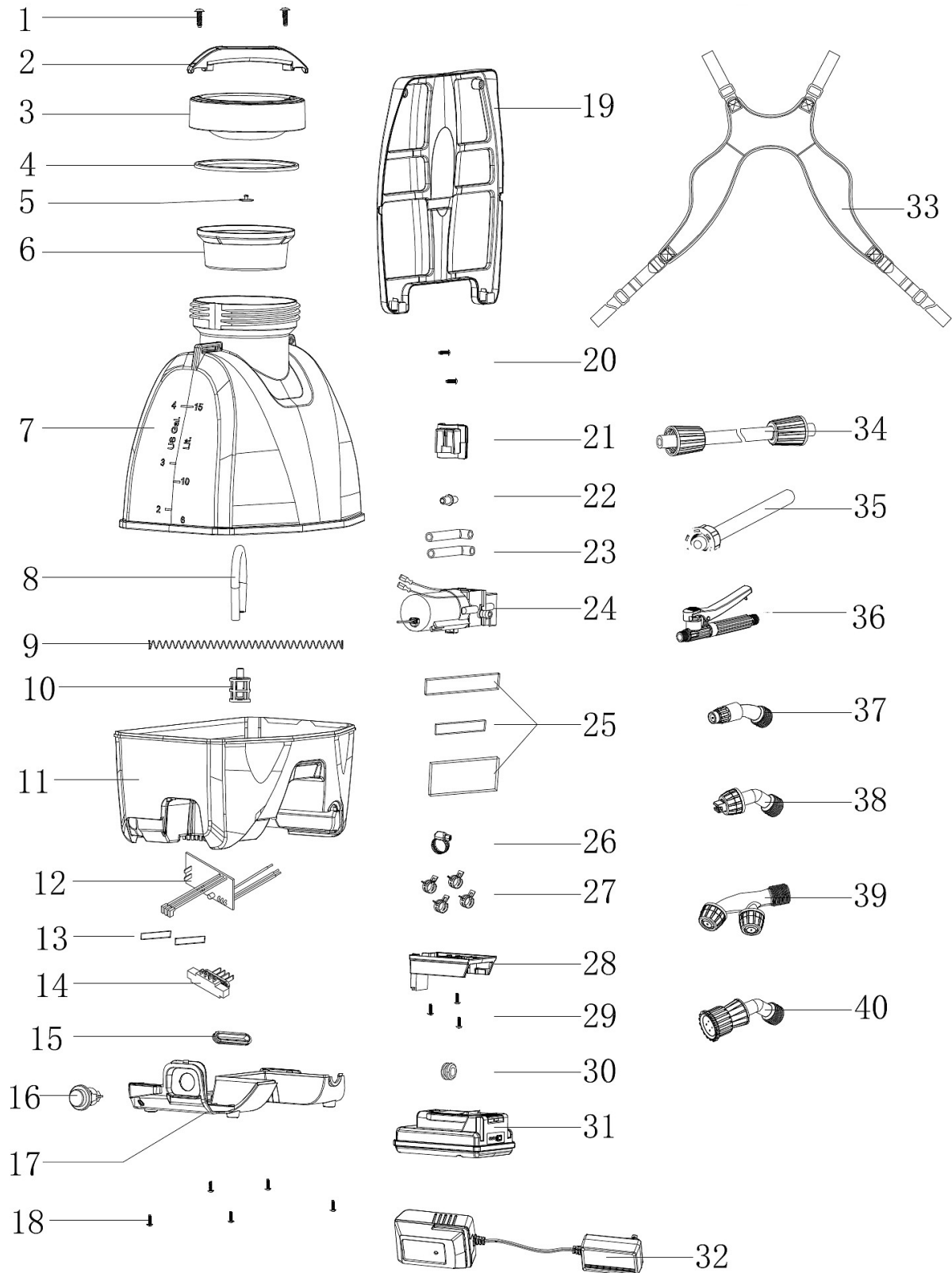

Fig. 26: Spare parts drawing 1

Parts list:

Pos.	Designation	Qty.		Pos.	Designation	Qty.
1	Screw	2		21	Hook for lance	1
2	Grip	1		22	Inlet line connector	1
3	Cover disc	1		23	Inlet pipe	2
4	Sealing ring	1		24	Pump	1
5	Waterproofing membrane	1		25	Pump label	1
6	Prefilter	1		26	Hose clamp	1
7	Tank	1		27	Elastic clamp	4
8	Connecting tube	1		28	Battery pack socket	1
9	Inlet line spring	1		29	Screw	3
10	Exhaust filter component	1		30	Outlet pipe jacket	1
11	Lower part tank	1		31	Battery pack	
12	Circuit board	1		32	Charger	1
13	Circuit board EVA label	2		33	Belt/Strap	1
14	Plug connection component	1		34	rod components	1
15	Seam sealing	1		35	Outlet pipe assemble	1
16	Switch	1		36	Spray gun	1
17	Base housing	1		37	Conical nozzle	1
18	Screw	5		38	Flat blower nozzle	1
19	Back board	1		39	Double-holed nozzle	1
20	Screw	2		40	Adjustable shower nozzle	1

13 Electrical wiring diagram

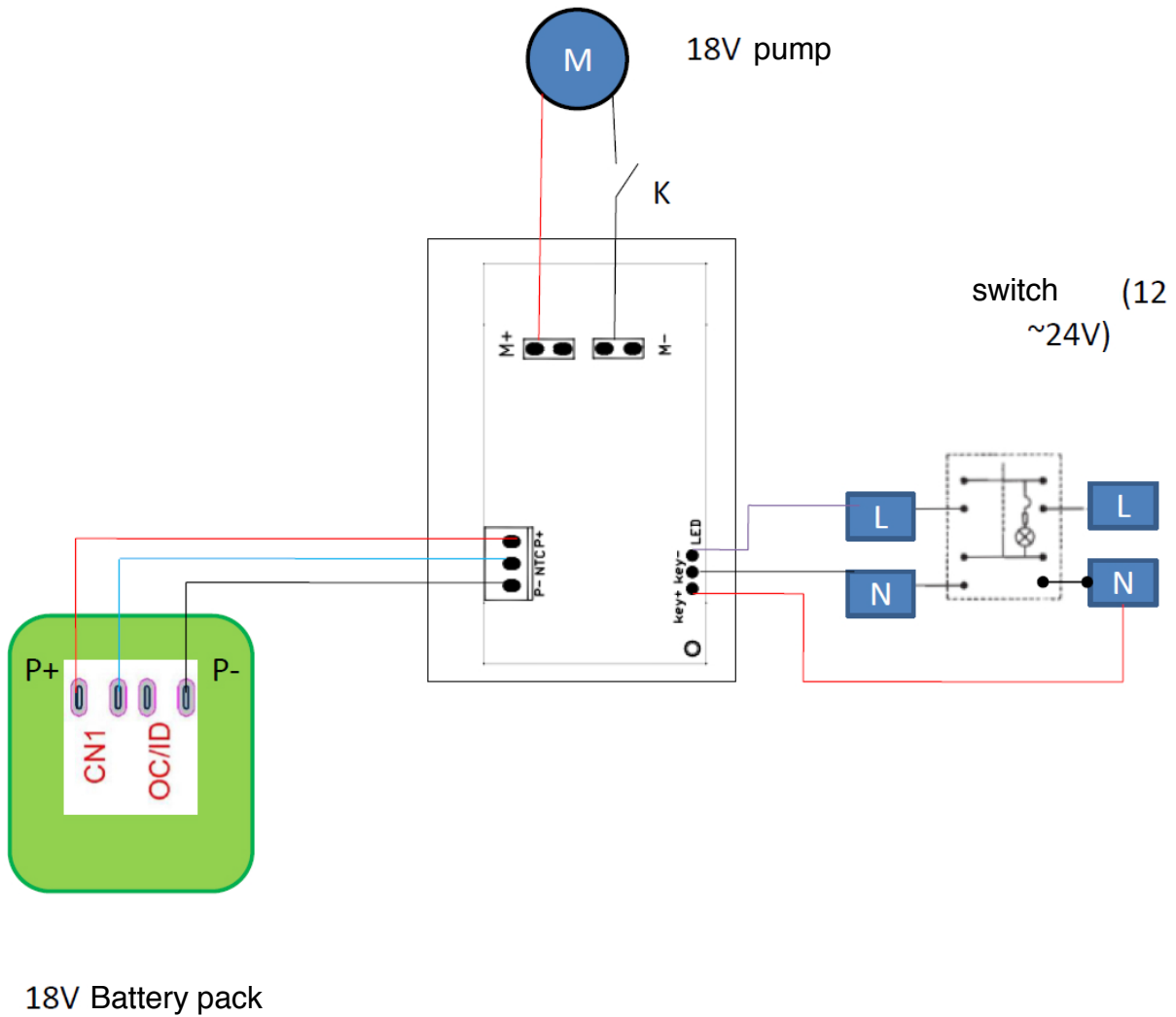

Fig. 27: Electrical wiring diagram

14 EC Declaration of Conformity

According to Machinery Directive 2006/42/EC, Annex II 1.A

Manufacturer / disturber: Stürmer Maschinen GmbH
Dr.-Robert-Pfleger-Str. 26
D-96103 Hallstadt

hereby declares that the following product

Product group: Cleancraft® Cleaning technology
Type of machine: Battery-operated Pressure Sprayer
Designation of the machine: AD SG 15
Item number: 7350000
Serial number*: _____
Year of manufacture*: 20_____

* fill in these data according to the information on the type plate

complies with all relevant provisions of the above mentioned directive as well as the other applied directives (below) - including their applicable modifications at the time of the declaration.

Relevant EU Directives: 2011/65 /EU RoHS Directive
2014/30/EU EMV-Directive

The following harmonized standards were applied:

DIN EN 19932-1:2013 -12	Equipment for crop protection - Knapsack sprayers - Part 1: Safety and environmental requirements;
DIN EN 19932-2:2014-09	Equipment for crop protection - Knapsack sprayers - Part 2: Test methods;
DIN EN ISO 12100:2011-03	Safety of machinery — General principles for design - Risk assessment and risk reduction;
DIN EN 55014-1:2018-08	Electromagnetic compatibility - Requirements for household appliances, electric tools and similar apparatus - Part 1: Emission
DIN EN IEC 61000-3-2:2019-12	Electromagnetic compatibility (EMC) - Part 3-2: Limits - Limits for harmonic current emissions (equipment input current \leq 16 A per phase)
DIN EN 61000-3-3:2020-07	Electromagnetic compatibility (EMC) - Part 3-3: Limits - Limitation of voltage changes, voltage fluctuations and flicker in public low-voltage supply systems, for equipment with rated current \leq 16 A per phase and not subject to conditional connection
DIN EN 55014-2:2016-01	Electromagnetic compatibility - Requirements for household appliances, electric tools and similar apparatus- Part 2: Immunity - Product family standard (CISPR 14-2:2015)

Responsible for documentation: Kilian Stürmer, Stürmer Maschinen GmbH,
Dr.-Robert-Pfleger-Str. 26, D-96103 Hallstadt

Hallstadt, 09.08.2022



Kilian Stürmer
Manager



