

de	Originalbetriebsanleitung - Einhandhobel	8
en	Original Instructions - One-handed planer	13
fr	Notice d'utilisation d'origine - rabot à une main	18
es	Manual de instrucciones original - Cepillo monomanual	23
it	Istruzioni d'uso originali - Pialletto monomanuale	28
nl	Originele gebruiksaanwijzing - eenhandschaaf	33
sv	Originalbruksanvisning - enhandshyvel	38
fi	Alkuperäiset käyttöohjeet - Yhdenkädenhöylä	43
da	Original brugsanvisning - Énhåndshøvl	48
nb	Bruksanvisning - enhåndshøvel	53
pt	Manual de instruções original - Plaina monomanual	58
ru	Оригинальное руководство по эксплуатации — Рубанок, управляемый одной рукой	63
cs	Originální návod k obsluze – jednoruční hoblík	68
pl	Oryginalna instrukcja obsługi - strug jednoręczny	73

## EHL 65 EQ

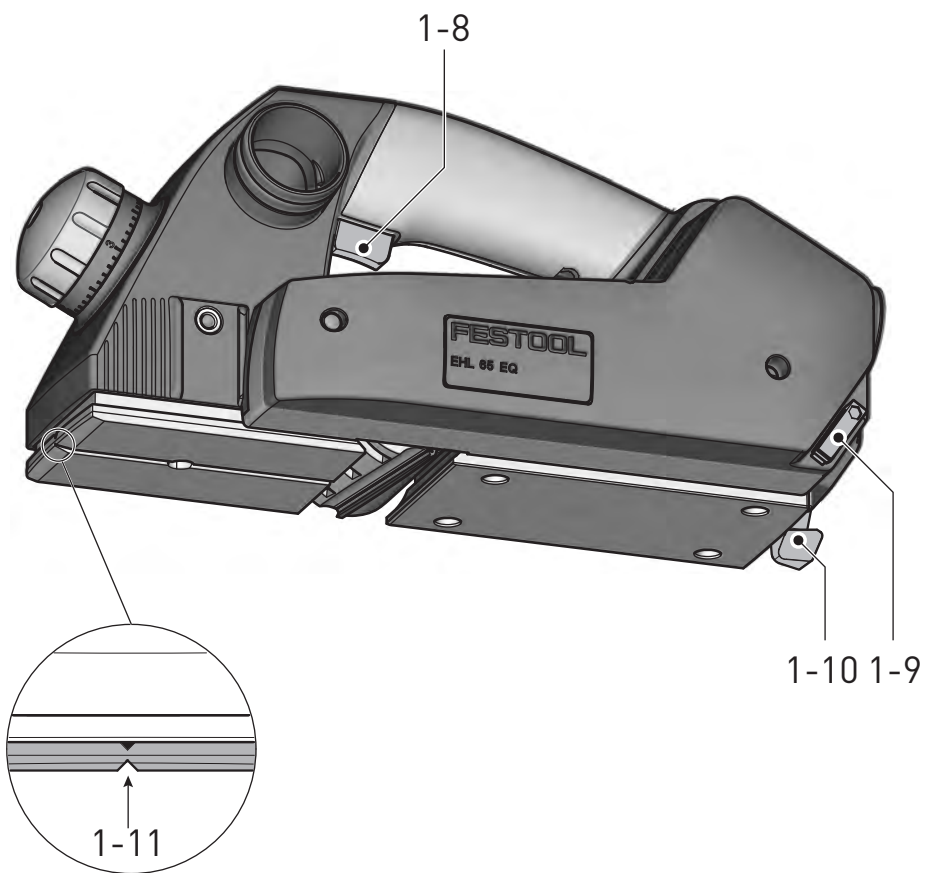

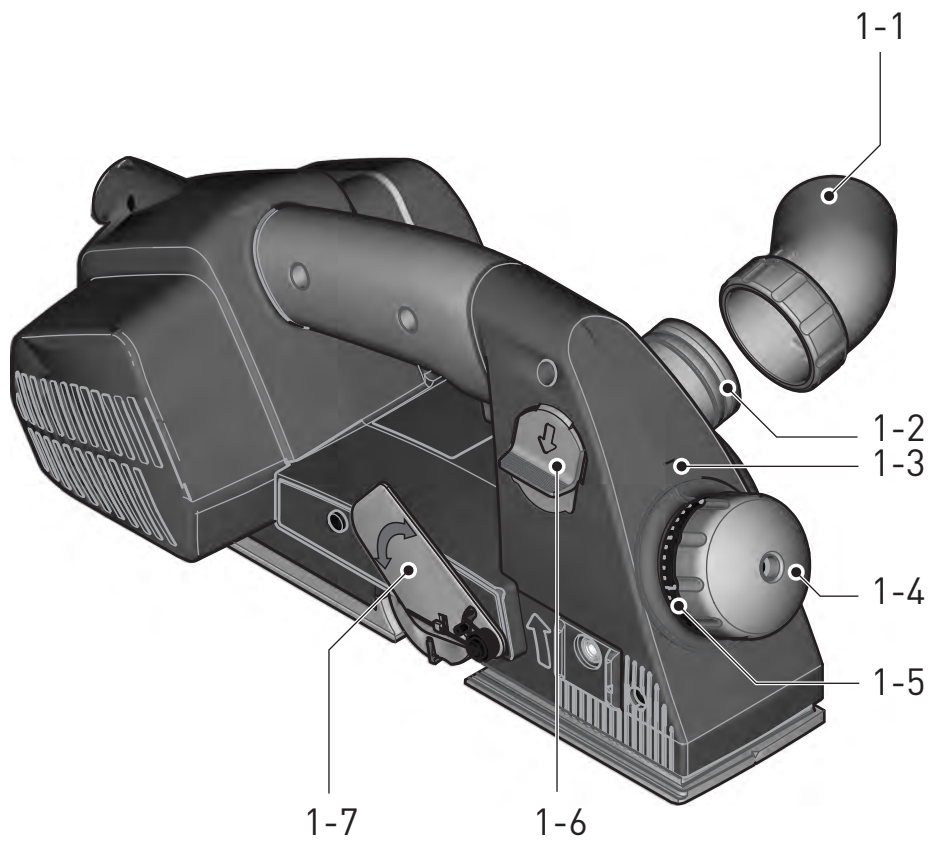

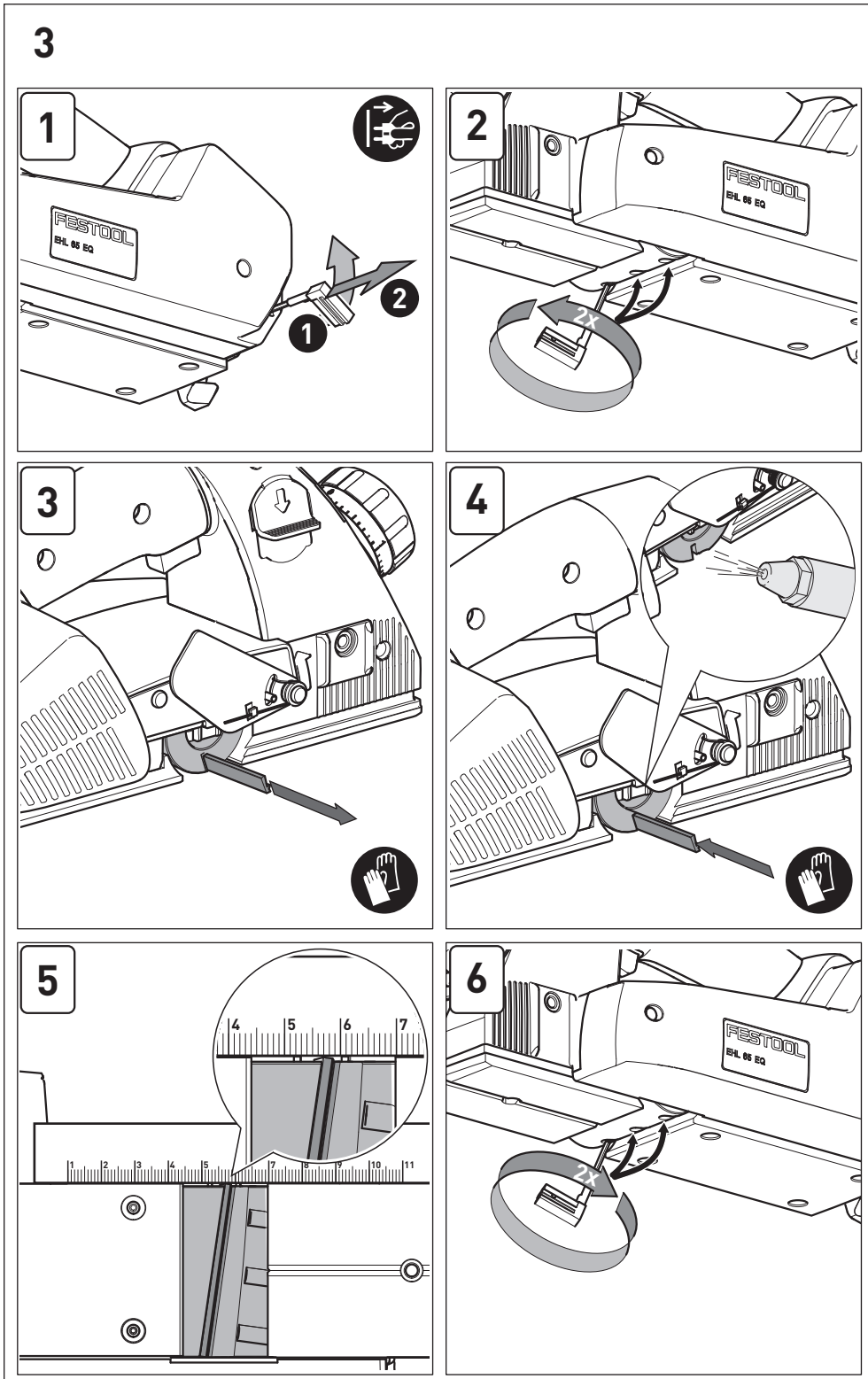
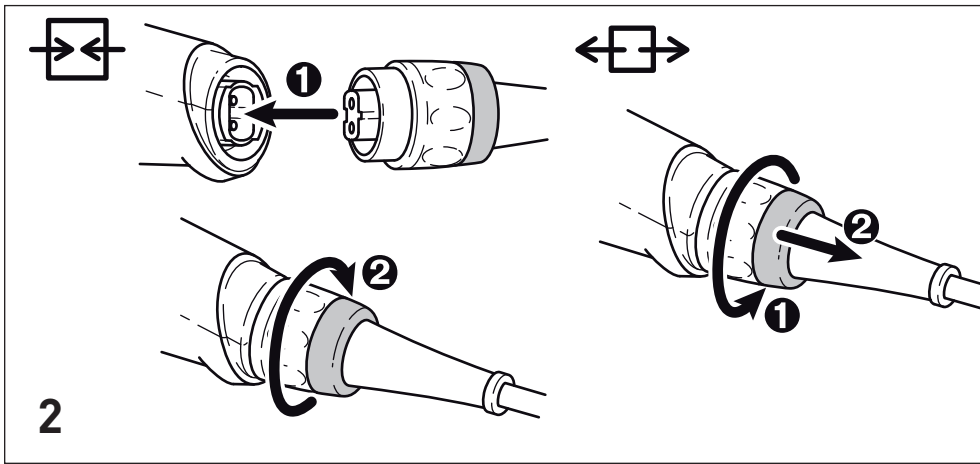

**4**

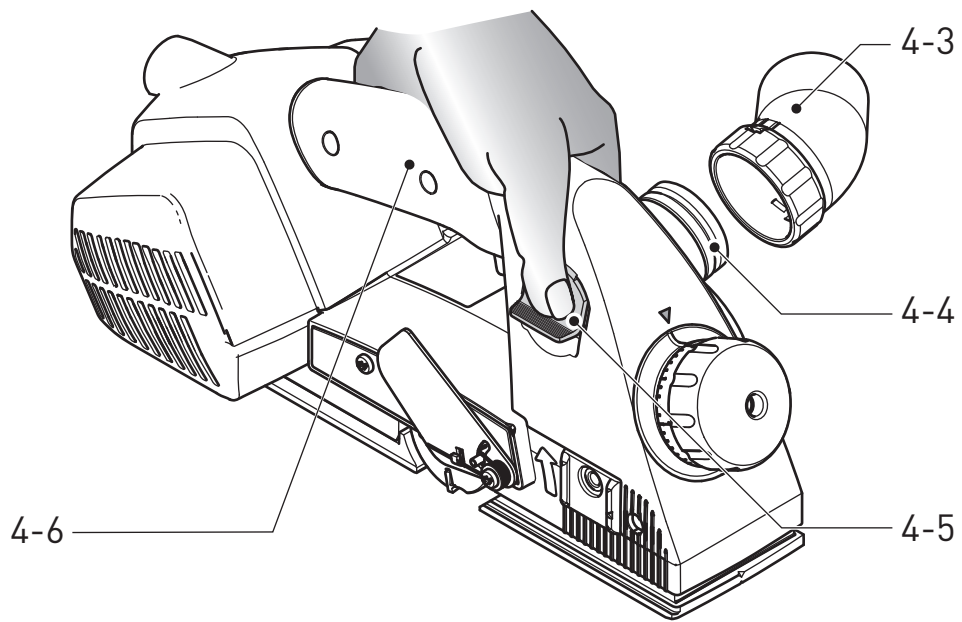
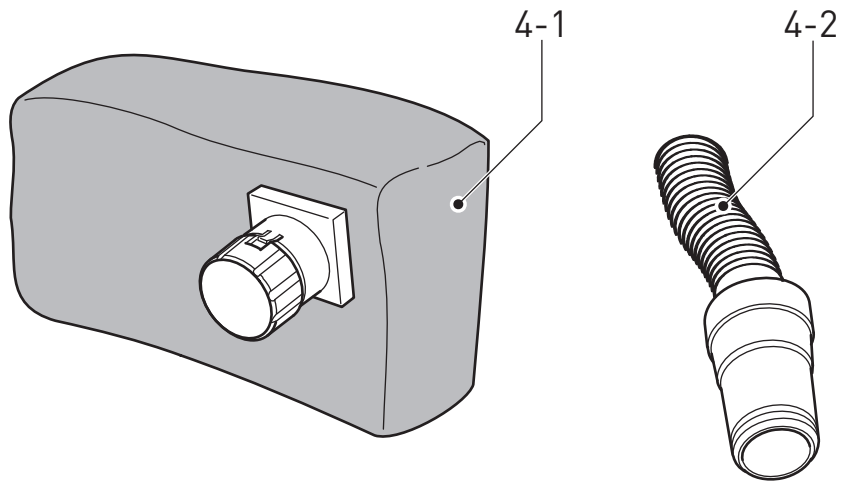

**4A**

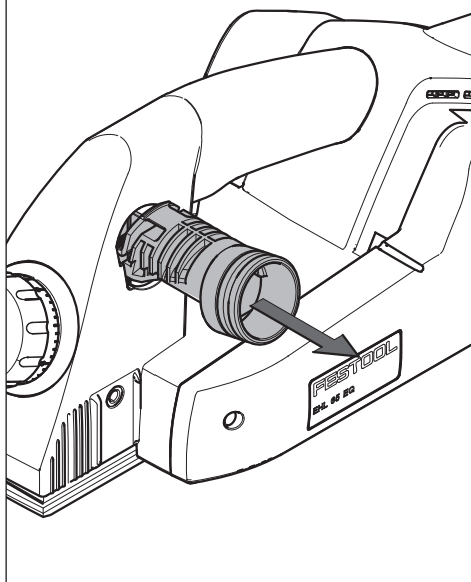

**4B**

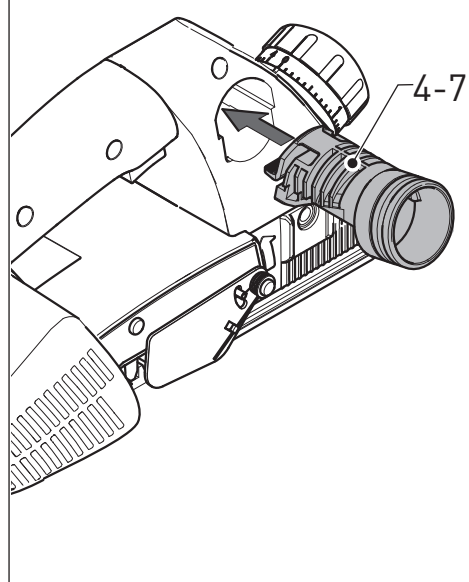

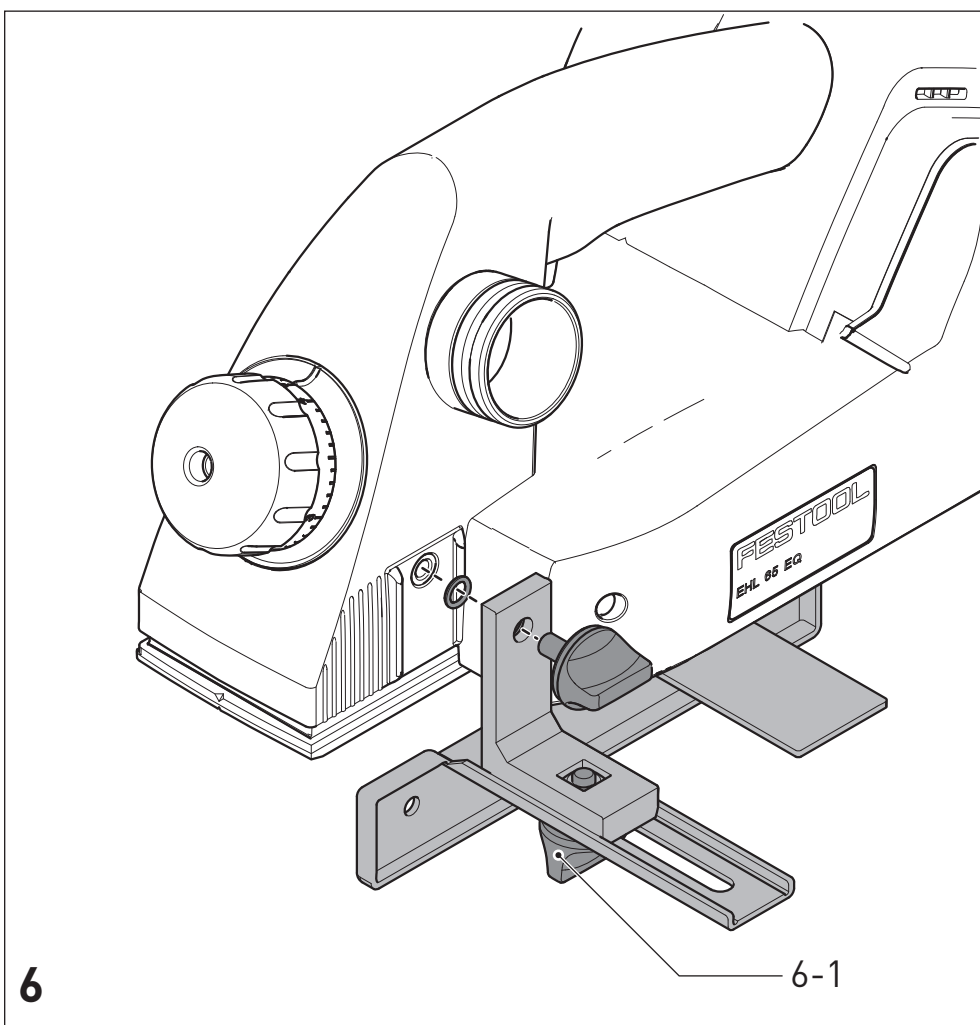
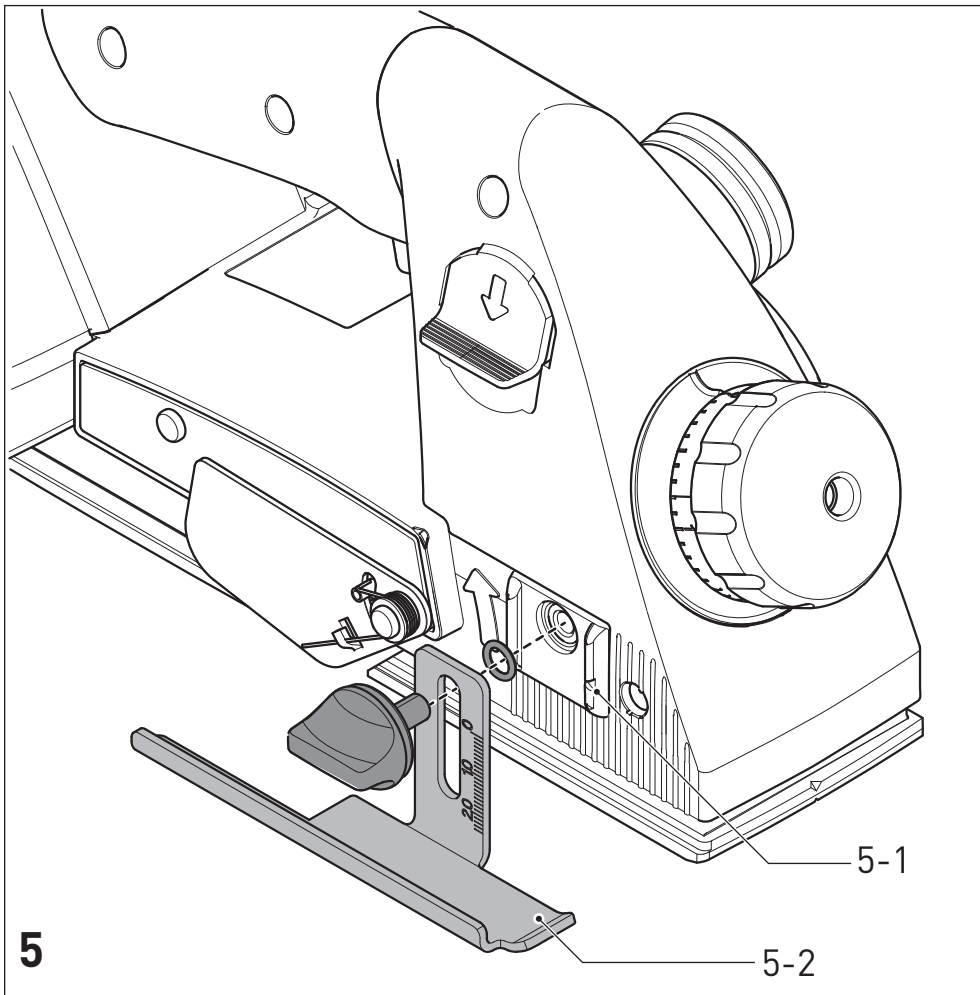

## *Declaration of Conformity*

We as the manufacturer **Festool GmbH, Wertstraße 20, 73240 Wendlingen, Germany** declare under our sole responsibility that the product(s):

Designation: **One-handed planer**  
Designation of Type(s): **EHL 65 EQ**  
Serial number(s) <sup>1)</sup>: **205165, 205169**

fulfills all the relevant provisions of the following UK Regulations:

- S.I. 2008/1597 Supply of Machinery (Safety) Regulations 2008
- S.I. 2016/1091 Electromagnetic Compatibility Regulations 2016
- S.I. 2012/3032 Restriction of the Use of Certain Hazardous Substances in Electrical and Electronic Equipment Regulations 2012

and are manufactured in accordance with the following designated standards:

- BS EN 62841-1: 2015
- BS EN 62841-2-14: 2015
- BS EN 55014-1:2017
- BS EN 55014-2:2015
- BS EN IEC 61000-3-2:2019
- BS EN 61000-3-3:2013
- BS EN IEC 63000:2018

<sup>1)</sup> in the specified serial number range (S-Nr.) from 400000000 – 499999999



Place and date of declaration: Wendlingen, 15.04.2021

Signed on behalf of and in name of Festool GmbH

A blue ink signature of Markus Stark, written in a cursive style.

Markus Stark  
Head of Productdevelopment

A blue ink signature of Ralf Brandt, written in a cursive style.

Ralf Brandt  
Head of Productconformity

Einhandhobel One-handed planer Rabot à une main	Seriennummer * Serial number * N° de série * (T-Nr.)
EHL 65 EQ	205165, 205166, 205168, 205169

**de EG-Konformitätserklärung.** Wir erklären in alleiniger Verantwortung, dass dieses Produkt allen einschlägigen Bestimmungen der folgenden Richtlinien einschließlich ihrer Änderungen entspricht und mit den folgenden Normen übereinstimmt:

**en EC-Declaration of Conformity.** We declare under our sole responsibility that this product is in conformity with all relevant provisions of the following directives including their amendments and complies with the following standards:

**fr CE-Déclaration de conformité communautaire.** Nous déclarons sous notre propre responsabilité que ce produit est conforme aux normes ou documents de normalisation suivants:

**es CE-Declaración de conformidad.** Declaramos bajo nuestra exclusiva responsabilidad que este producto corresponde a las siguientes normas o documentos normalizados:

**it CE-Dichiarazione di conformità.** Dichiariamo sotto la nostra esclusiva responsabilità che il presente prodotto è conforme alle norme e ai documenti normativi seguenti:

**nl EG-conformiteitsverklaring.** Wij verklaren op eigen verantwoordelijkheid dat dit produkt voldoet aan de volgende normen of normatieve documenten:

**sv EG-konformitetsförklaring.** Vi förklarar i eget ansvar, att denna produkt stämmer överens med följande normer och normativa dokument:

**fi EY-standardinmukaisuusvakuutus.** Vakuutamme yksinvastuullisina, että tuote on seuraavien standardien ja normatiivisten ohjeiden mukainen:

**da EF-konformitetserklæring.** Vi erklærer at have alene ansvaret for, at dette produkt er i overensstemmelse med de følgende normer eller normative dokumenter:

**nb CE-Konformitetserklæring.** Vi erklærer på eget ansvar at dette produktet er i overensstemmelse med følgende normer eller normative dokumenter:

**pt CE-Declaração de conformidade.** Declaramos, sob a nossa exclusiva responsabilidade, que este produto corresponde às normas ou aos documentos normativos citados a seguir:

**ru Декларация соответствия ЕС.** Мы заявляем с исключительной ответственностью, что данный продукт соответствует следующим нормам или нормативным документам:

**cs ES prohlášení o shodě.** Prohlašujeme s veškerou odpovědností, že tento výrobek je ve shodě s následujícími normami nebo normativními dokumenty:

**pl Deklaracja o zgodności z normami UE.** Niniejszym oświadczamy na własną odpowiedzialność, że produkt ten spełnia następujące normy lub dokumenty normatywne:

2006/42/EG, 2014/30/EU, 2011/65/EU

EN 62841-1: 2015 + AC:2015,  
EN 62841-2-14: 2015, EN 55014-1: 2017,  
EN 55014-2: 2015, EN 61000-3-2: 2014,  
EN 61000-3-3: 2013, EN 50581: 2012

**CE Festool GmbH**  
Wertstr. 20, D-73240 Wendlingen  
GERMANY

Wendlingen, 2019-08-01



Markus Stark  
Head of Product Development

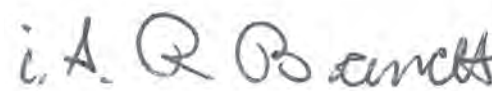

Ralf Brandt  
Head of Product Conformity

\* im definierten Seriennummer-Bereich (S-Nr.) von 40000000 - 49999999  
in the specified serial number range (S-Nr.) from 40000000 - 49999999  
dans la plage de numéro de série (S-Nr.) de 40000000 - 49999999

## Contents

1	Symbols.....	13
2	Safety warnings.....	13
3	Intended use.....	14
4	Technical data.....	14
5	Machine features.....	14
6	Commissioning.....	15
7	Settings.....	15
8	Working with the machine.....	16
9	Service and maintenance.....	16
10	Accessories.....	17
11	Environment.....	17
12	General information.....	17

## 1 Symbols



Warning of general danger



Read the operating instructions and safety instructions.



Warning of electric shock



Wear ear protection.



Wear protective goggles.



Wear a dust mask.



Wear protective gloves.



Pull out the mains plug



Do not dispose of it with domestic waste.



Tip or advice



Handling instruction



Safety class II



CE marking: Confirms the conformity of the power tool with the European Community directives.



UKCA marking: The United Kingdom Conformity Assessed symbol is a marking for products being placed on the market in the United Kingdom. It is a manufacturer's indication that the product is in conformance with the relevant regulations in the UK.

## 2 Safety warnings

### 2.1 General power tool safety warnings



**WARNING! Read all safety warnings, instructions, illustrations and specifications provided with this power tool.** Failure to follow all instructions listed below may result in electric shock, fire and/or serious injury.

**Save all warnings and instructions for future reference.**

The term "power tool" in the warnings refers to your mains-operated (corded) power tool or battery-operated (cordless) power tool.

### 2.2 Machine-specific safety notices

- **Wait for the cutter to stop before setting the tool down.** An exposed rotating cutter may engage the surface leading to possible loss of control and serious injury.
- **Hold the power tool by insulated gripping surfaces, because the cutter may contact its own cord.** Cutting a "live" wire may make exposed metal parts of the power tool "live" and could give the operator an electric shock.
- **Fasten and secure the workpiece on a stable base using clamps or by some other means.** If you only hold the workpiece in place using your hand or against your body, it remains unstable, which can result in a loss of control.
- **Festool electric power tools must only be installed on work tables provided by Festool for this purpose.** If the tool is installed in another, or self-made, work table, it can become unstable and result in serious accidents.
- Check the plunging mechanism prior to use and do not use the machine if it does not work correctly.



**Wear suitable personal protective equipment:** Ear protection, protective goggles, dust mask for work that generates dust,



- protective gloves for working with rough materials and for changing tools.
- Check the plug and the cable regularly and should either become damaged, in order to avoid a hazard, have them replaced by an authorised after-sales service workshop.
- **Only for AS/NZS:** The tool shall always be supplied via residual current device with a rated residual current of 30 mA or less.

### 2.3 Emission levels

The levels determined in accordance with EN 62841 are typically:

Sound pressure level	$L_{PA} = 87 \text{ dB(A)}$
Sound power level	$L_{WA} = 98 \text{ dB(A)}$
Uncertainty	$K = 3 \text{ dB}$



#### CAUTION

##### Noise generated when working

##### Risk of damage to hearing

- Use ear protection.

Vibration emission level  $a_h$  (vector sum for three directions) and uncertainty K measured in accordance with EN 62841:

$$a_h < 2,5 \text{ m/s}^2$$

$$K = 1.5 \text{ m/s}^2$$

The specified emission levels (vibration, noise)

- are used to compare machines.
- They are also used for making preliminary estimates regarding vibration and noise load during operation.
- They represent the primary applications of the power tool.



#### CAUTION

**The emission values may deviate from the specified values. This is dependent on how the tool is used and the type of workpiece being machined.**

- The actual load during the entire operating cycle must be evaluated.
- Depending on the actual load, suitable protective measures must be defined in order to protect the operator.

### 3 Intended use

One-handed planer suitable for machining

- wood, soft plastics and wood-based materials,

- only with the tools offered by Festool.

This power tool is only designed and approved to be used by trained personnel or experts.

Usage permitted only with planer heads designed for maximum speed of 22000 rpm.



The user is liable for improper or non-intended use.

### 4 Technical data

One-handed planer	EHL 65 EQ
Power	720 W
Speed (no-load) $n_0$	15,600 rpm
Planing width	65 mm
Planing depth	0–4 mm
Max. rebate depth	23 mm
Weight as per EPTA-Procedure 01:2014	2.4 kg

### 5 Machine features

- [1-1]** Angle adapter for attaching a suction hose
- [1-2]** Extractor connector
- [1-3]** Marking for setting the planing thickness
- [1-4]** Planing thickness adjuster
- [1-5]** Scale indicating planing thickness
- [1-6]** Button for switching the extractor connector to the other side
- [1-7]** Cover for spiral blade
- [1-8]** On/Off switch
- [1-9]** Allen key
- [1-10]** Support foot
- [1-11]** V groove for chamfering

The specified illustrations appear at the beginning of the Operating Instructions.

## 6 Commissioning



### WARNING

#### Unauthorised voltage or frequency.

##### Risk of accidents

- ▶ The mains voltage and the frequency of the power source must correspond to the specifications on the name plate.
- ▶ In North America, only Festool machines with the voltage specifications 120 V/60 Hz may be used.



### CAUTION

#### Heating of the Plug it connection if bayonet fitting is not completely locked

##### Risk of burns

- ▶ Before switching on the power tool, make sure that the bayonet fitting at the mains cable is closed fully and locked.



### WARNING

#### Risk of injury

- ▶ Always switch off the machine before connecting and disconnecting the mains power cable.

Connecting and detaching the mains power cable - see figure [2].

To switch on: Press [1-8]

To switch off: Release [1-8]

## 7 Settings



### WARNING

#### Risk of injury, electric shock

- ▶ Always disconnect the mains plug from the socket before performing any work on the machine.

### 7.1 Electronics

The machine features full-wave phase control electronics with the following features:

#### Smooth start-up

The electronically controlled smooth start-up ensures that the machine starts up jolt-free.

#### Constant speed

The motor speed remains constant through electronic control to ensure a uniform cutting speed even when under load.

### Temperature cut-out

When exceeding a certain engine temperature level, the machine power supply and speed are capped. The power tool continues operating at reduced power to allow the ventilator to cool the motor rapidly. The power tool resumes to full performance automatically once the motor has cooled sufficiently.

### 7.2 Adjusting the planing thickness

- ▶ Use the rotary knob [1-4].



increase planing depth



decrease planing depth

The marking [1-3] on the scale [1-5] around the rotary knob indicates the planing depth setting.

- ⓘ The space between two lines on the scale represents a change in the planing depth of approx. 0.1 mm .

**Recommendation:** do not set a planing thickness greater than 2.5 mm for planing widths over 40 mm.

### 7.3 Changing spiral blades [3]



### WARNING

#### Worn spiral blades pose a risk of kickback and could result in poor quality planing work

- ▶ Always use sharp, undamaged spiral blades.
- ▶ Remove the Allen key.
- ▶ Loosen three clamping screws on the planer shaft.



### CAUTION

#### Hot and sharp tools

##### Risk of injury

- ▶ Do not use insert tools that are blunt or defective.
- ▶ Wear protective gloves.
- ▶ Remove the spiral blade.
- ▶ Clean the blade retaining groove.
- ▶ Insert spiral blade HW65 (488 503) with the labelled side facing the rear planer foot.
- ▶ Align the spiral blade using a ruler so that the face end is flush with the lateral edges of the front and rear planer foot.
- ▶ Tighten the clamping screws (starting with the central clamping screw).

- i** If the planer blade protrudes slightly towards either the inner or outer sides of the planer head, this will lead to a distorted cut width while rebating.

## 7.4 Dust extraction



### WARNING

#### Health hazard posed by dust

- ▶ Always work with an extractor.
- ▶ Comply with national regulations.

Dust extraction possible with:

- Chip collection bag **[4-1]** (accessory) on the extractor connector **[4-4]**
- Mobile dust extractor with a suction hose **[4-2]** with a dia. of 27 or dia. of 36 (accessory) on the angle adapter **[4-3]**

It is possible to connect the dust extractor on both sides of the device:

- ▶ Press the **[4-5]** button down firmly.
- ▶ Pull out the connecting adapter on the opposite side **[4]**.
- ▶ With the button at the front, insert it into the housing opening as far as it will go **[4B]**

The chip ejection can be set in any direction by turning the angle adapter **[4-3]**.

## 8 Working with the machine



### WARNING

#### Risk of injury, damage to the spiral blade

- ▶ The surface to be planed must be free of metals.



Wear a dust mask.

When working, guide the power tool with one hand on the handle **[4-6]**. Keep your other hand out of the hazard area.

- ▶ Set the required chip thickness (see section **7.2**).
- ▶ Place the planer with the front of the planer foot on the workpiece without touching the workpiece with the planing head.
- ▶ Switch on the planer.
- ▶ Guide the planer over the workpiece so that the planer foot lies flat on the workpiece.
  - ▷ Apply pressure to the front of the planer foot when starting to plane.
  - ▷ Apply pressure to the rear of the planer foot for the remainder of the planing process.

## 8.1 Setting down the planer



### WARNING

#### Risk of injury

- ▶ Do not use unless the support foot **[1-10]** is fully functional.
- ▶ The planer shaft continues to rotate for a few seconds after the machine is switched off. Wait until the planer shaft stops.

A support foot **[1-10]** is fitted to the end of the planer foot so that the EHL 65 EQ can be set down safely. When the machine is lifted up, the support foot automatically swivels over the edge of the planer foot so that the blade does not touch the surface when the planer is set down.

## 8.2 Chamfering

The front planer foot is fitted with a 90° V groove **[1-11]** for chamfering workpiece edges. The V groove is 2 mm deep so that 2 mm of the edge is chamfered when the planing thickness is set to 0.

## 9 Service and maintenance



### WARNING

#### Risk of injury, electric shock

- ▶ Always pull the mains plug from the socket before performing any servicing and maintenance work.
- ▶ All maintenance and repair work which requires the motor housing to be opened should always be carried out by an authorised service workshop.



FESTOOL

**Customer service and repairs** must only be carried out by the manufacturer or service workshops. Find the nearest address at:  
[www.festool.co.uk/service](http://www.festool.co.uk/service)



FESTOOL

Always use original Festool spare parts. Order no. at:  
[www.festool.co.uk/service](http://www.festool.co.uk/service)

To ensure constant air circulation, always keep the cooling air openings in the motor housing clean and free of blockages.

The tool is equipped with special self-disconnecting carbon brushes. If they wear out, the power supply is disconnected automatically and the tool stops.

**To clean the chip ejector:**

- ▶ Remove the adapter [4-7] (if applicable).
- ▶ Empty the adapter, remove any blockages.
- ▶ Release any chips jammed in the ejector opening [4-4], if necessary clean the machine with a resin-based solvent.
- ▶ Connect the dust extractor (section 7.4) and extract dust from the chip ejector opening.

**10 Accessories**

The order numbers of the accessories and tools can be found in the Festool catalogue or on the Internet at "www.festool.com".

**10.1 Fitting the rebate depth stop [5]**

The rebate depth stop [5-2] can be adjusted in infinite variables to a setting between 0 to 23 mm. The marking [5-1] indicates the rebate depth setting.

**10.2 Fitting the parallel stop [6]**

In order to plane along an edge, the planing width can be adjusted from 0 to 65 mm by releasing the clamp [6-1] and adjusting the stop.

**11 Environment**

**Do not dispose of the device in the household waste!** Recycle devices, accessories and packaging. Observe applicable national regulations.

**EU only:** In accordance with the European Directive on waste electrical and electronic equipment and implementation in national law, used power tools must be collected separately and handed in for environmentally friendly recycling.

**Information on REACH:** [www.festool.com/reach](http://www.festool.com/reach)

**12 General information****Imported into the UK by**

Festool UK Ltd  
1 Anglo Saxon Way  
Bury St Edmunds  
IP30 9XH  
Great Britain