

Instruction Manual

_____ Chip extraction unit

_____ SAA 902



SAA 902

SAA 902

Imprint

Product identification

Chip extraction unit	Item number
SAA 902	5923902

Manufacturer

Stuermer Maschinen GmbH
 Dr.-Robert-Pfleger-Str. 26
 D-96103 Hallstadt

Fax: 0049 (0) 951 96555 - 55

E-Mail: info@holzstar.de
 Internet: www.holzstar.de

Information about the operating instructions

Original operating instructions

Published: 23.03.2021
 Version: 1.04
 Language: English

Author: FL

Copyright information

Copyright © 2021 Stürmer Maschinen GmbH, Hallstadt, Germany.

Stürmer Maschinen GmbH is the sole owner of the content of these operating instructions. Forwarding and reproduction of this document as well as use and notification of its content is not permitted without explicit consent. Infringements will lead to claims for damages.

Subject to technical changes and errors.

Contents

1 Introduction	3
1.1 Copyright	3
1.2 Customer service	3
1.3 Disclaimer	3
2 Safety	3
2.1 Legend of symbols	3
2.2 Operator responsibility	4
2.3 Operating staff qualification	4
2.4 Personal protective equipment	5
2.5 Safety labels on the Chip extraction unit	5
2.6 General safety aspects	6
2.7 Safety measures when dealing with electricity ...	7
2.8 Safety measures for the use of tools	7
2.9 Safety measures for processing	7
2.10 Safety measures during maintenance and servicing	8
2.11 Safety check	8
3 Intended Use	8
3.1 Residual risks	8
4 Description of the device	9
4.1 Machine	9
4.2 Scope of supply	9
5 Technical Data	9
5.1 Table	9
5.2 Type plate	9
5.3 Accessories	9
6 Transport, packaging, storage	10
6.1 Delivery and transport	10
6.2 Packaging	10
6.3 Storage	10
6.4 Installation and connection	10
6.5 Requirements to the installation location	10
6.6 Assembly of the extraction system	10
6.7 Setting up the chip extraction unit	12
6.8 Commissioning of the chip extraction unit	13
6.9 Electrical connection	13
6.10 Static charge	13
7 Operation	13
7.1 Switch on	13
7.2 Switch off	13
7.3 Emptying the chip collecting bag	13
7.4 Transport of the extraction system	14
8 Care, maintenance and repair	14
8.1 Cleaning	14
9 Troubleshooting	15
10 Disposal, reusing used machines	15
10.1 Decommissioning	15
10.2 Disposal of electrical equipment	15
10.3 Disposal via municipal collection points	15
11 Spare parts	16
11.1 Ordering spare parts	16
11.2 Spare parts drawing	17
12 Electrical schematic	18
13 EC - Declaration of Conformity	19

1 Introduction

You have made an excellent choice in purchasing a HOLZSTAR Chip Extraction Unit.

Carefully read the operating instructions prior to commissioning.

They describe correct commissioning, intended use and safe as well as efficient operation and maintenance of the Chip Extraction Unit.

The operating instructions form part of the Chip Extraction Unit. Always keep them at the Chip Extraction Unit's location of use. Please also observe the local accident prevention regulations and general safety regulations for the use of the Chip Extraction Unit.

1.1 Copyright

The contents of these operating instructions are protected by copyright. Their use is permitted within the context of using the Chip Extraction Unit. Any further use shall not be permitted without written consent by the manufacturer.

To protect our products, we register our rights to our brands, patents and designs where possible in each individual case. We take strong action against any violation of our intellectual property.

1.2 Customer service

Please contact your specialist retailer if you have any questions regarding your Extraction Unit or require any technical information. Your specialist retailer will be happy to support you with specialist advice and information.

Germany:

Stürmer Maschinen GmbH
Dr.-Robert-Pfleger-Str. 26
D-96103 Hallstadt

Repair service:

Fax: 0049 (0) 951 96555-111
E-Mail: service@stuermer-maschinen.de
Internet: www.holzstar.de

Spare parts orders:

Fax: 0049 (0) 951 96555-119
E-Mail: ersatzteile@stuermer-maschinen.de

Please submit any information and experiences you make during application of the machine as these may be valuable for product improvements.

1.3 Disclaimer

All data in this operation manual has been compiled on the basis of the state-of-the-art, valid standards and guidelines as well as our many years of expertise and experience.

The manufacturer shall not be liable for damage in the following cases:

- Failure to comply with the operation manual,
- Unintended use
- Deployment of untrained staff
- Conversions at one's own responsibility
- Technical modifications
- Use of unauthorised spare parts

The actual scope of delivery may deviate from the descriptions and illustrations in this document as a result of special variants, optional extras or recent, technical modifications. The obligations defined in the supply contract shall apply in addition to the general terms and conditions and the manufacturer's general terms and conditions as well as the statutory regulations valid at the time of the conclusion of the contract.

2 Safety

This section provides an overview of all important safety packages for personal protection as well as safe and reliable operation. The individual sections contain additional, task-specific safety information.

2.1 Legend of symbols

Safety instructions

Safety instructions in this operation manual have been highlighted with symbols. Safety instructions are indicated by signal terms that express the degree of risk involved.



DANGER!

This combination of symbol and signal term indicates a directly dangerous situation which may cause death or serious injury if not averted.



WARNING!

This combination of symbol and signal term indicates a potentially hazardous situation which may cause minor or light injuries if it is not averted.



IMPORTANT!

This combination of symbol and signal term indicates a potentially dangerous situation which may cause material damage or harm the environment if it is not averted.



ATTENTION!

This combination of symbol and signal word indicates a potentially hazardous situation which, if not avoided, could result in material and environmental damage.



NOTE!

This combination of symbol and signal term indicates a potentially dangerous situation which may cause material damage or harm the environment if it is not averted.

Tips and recommendations



Tips and recommendations

This symbol highlights useful tips and recommendations as well as information for efficient and reliable operation.

Observe the safety information in these operating instructions to minimise the risk of personal injury as well as material damage and prevent hazardous situations.

2.2 Operator responsibility

Operators are defined as the persons who operate the machine for commercial or profit-based purposes or provide the machine to third parties for use or application and bear the legal product responsibility in terms of the protection of users, staff or third parties during operation.

Obligations of the operator:

If the machine is used for commercial purposes, operators are subject to the legal stipulations in terms of occupational safety. For this reason, the safety instructions in these operating instructions as well as the safety, accident prevention and environmental protection regulations valid at the installation location must be complied with. In this process, the following shall apply in particular:

- Operators shall obtain information about valid occupational safety regulations and determine additional hazards as part of a risk assessment which result from the specific operating conditions at the machine's installation location. Said risk assessment shall be reflected in operating instructions for machine operation.
- During the entire machine operating time operators must check whether the operating instructions they created meet current standards and adapt the operating instructions where necessary.
- Operators shall clearly manage and specify the responsibilities for installation, operation, troubleshooting, maintenance and cleaning.
- Operators must make sure that all persons handling the machine have read and understood these operating instructions. Operators must also regularly train staff and notify of the hazards.
- Operators shall provide staff with the required protective equipment and wearing the required protective equipment shall be mandatory.

Operators shall also be responsible for maintaining the machine in a technically perfect condition. For this reason, the following shall apply:

- Operators shall make sure that the maintenance intervals described in these operating instructions are complied with.
- Operators shall regularly check that the safety equipment is fully functional and complete.

2.3 Operating staff qualification

The different tasks described in these operating instructions require different levels of skills in terms of the qualifications of operating staff working with the machine.



WARNING!

Risk from inadequately qualified persons!

Inadequately qualified persons are unable to assess the risks when handling the machine, thus putting themselves and others at risk of severe injuries.

- All work must be carried out by qualified persons only.
- Keep inadequately qualified persons and children away from the work area.

Exclusively persons of whom it can be expected that they reliably complete assigned tasks shall be authorized to carry out any tasks. Persons whose reactions have been impaired shall not be authorized, e.g. drug users, users under the influence of alcohol or medication.

These operating instructions specify the following personal qualifications for the different tasks:

Operating staff:

Operating staff has undergone an induction by the operator about the entrusted tasks and potential hazards resulting from improper behaviour. Tasks which go beyond normal operation may only be carried out by the operator if they are listed in the operation manual and the operator has made him/herself familiar with them.

Qualified electrician:

Due to the electrician's specialised training, know-how, experience and knowledge of pertinent standards and regulations the electrician is in a position to work on the electrical systems, and autonomously identify and avoid potential hazards.

Specialist staff:

As a result of specialist training, expertise, experience and skills in terms of the relevant standards and regulations, specialist staff is able to complete the tasks they are entrusted with and independently identify hazards and avert risks.

Manufacturer:

Certain work must be carried out by manufacturer specialist staff only. Other staff is not permitted to carry out this work. Contact our customer service to have the work carried out.

2.4 Personal protective equipment

Personal protective equipment is intended to protect the health and safety of persons at work. Staff must wear the personal protective equipment indicated in individual sections of these operating instructions when carrying out the different tasks on the machine.

The personal protective equipment is described in the following section:



Ear protection

The ear protection protects against hearing damage caused by noise.



Eye protection

Protective glasses protect the eyes against projected parts and splashes of liquid.



Protective gloves

Protective gloves protect the hands from components with sharp objects as well as friction, abrasion, and deep-cut injuries.



Protection of face

The face protection prevent the face of objects flying around.



Safety shoes

Safety shoes protect feet from pinching, falling parts and slipping on slippery surfaces.



Protective clothing

Protective work clothing means tight-fitting clothing with low tear resistance.

2.5 Safety labels on the Chip extraction unit

The following safety labels and instructions are attached to the Chip Extraction Unit s (Fig. 1) and must be observed.



Fig. 1: Safety signs

If safety labels on the machine are damaged or missing, this can cause errors, personal injury and material damage. The safety symbols attached to the machine must not be removed. Damaged safety symbols must be replaced immediately.

As soon as the signs are not clearly visible and comprehensible at first glance, the machine must be stopped until new signs have been attached.

2.6 General safety aspects

Note the following:



ATTENTION!

In spite of taking care of all working tips, security and accident prevention regulations a rest risk continues with the contact with the machine.

By concentrated and farsighted work and action you can diminish the rest risk.

- The extraction system may only be operated and maintained by persons who have read and understood this operating manual. The operator must be adequately trained in application, adjustment and operation.
- If you pass on this extraction system, you must hand over all the tools and documents supplied with the extraction system.
- Do not switch on the machine until immediately before commencing the extraction. Switch off the machine during breaks and when not in use. Do not leave the operating machine unattended.
- Never open the protective covers while the extraction system is running.
- Keep the workplace and the floor in the vicinity of the extraction system free of any objects that endanger your stability or pose a risk of tripping. Keep order in the workplace. Clutter can result in accidents.
- Before and during work, check the danger zone so that there are no unauthorized persons in it. Do not allow the suction system to be operated by other people, especially children.
- Do not use the machine near flammable gases, liquids and solids. There is a risk of explosion or fire due to possible flying sparks.
- Use the machine only in dry rooms or in a dry environment and ensure a sufficiently lit work area.
- Protect the machine from moisture and moisture to avoid electrical hazards.
- Maintain the machine with care in order to be able to work well and safely in the long term. Follow the instructions for maintenance.
- Never leave a running machine unattended. Switch off the machine before leaving the workplace.
- Wood dust is explosive and can be harmful to your health. In particular, tropical woods and hard woods such as beech and oak are classified as carcinogenic.
- Work with reason and concentration. Do not use the extraction system if you are not concentrated.
- Operation or maintenance of the extraction system is prohibited for persons under the age of 18 or under the influence of alcohol, drugs or medication.
- Defective or damaged parts in the device must be replaced immediately.
- Keep children away from the machine.
- Only operate the machine with fully and correctly installed safety devices and do not modify anything on the machine that could impair safety.
- There must be sufficient fresh air and light conditions.
- Before starting the extraction work, inform yourself about the type of material to be processed and about any health hazards caused by released dust. Take appropriate precautions, if necessary.
- When working with the extraction system always wear ear protection. The wearing of loose clothing (ties, scarves, open jackets and tight-fitting garments) is prohibited. There is a risk of injury from being caught or pulled into moving machine parts. For long hair, a hairnet should be worn.
- Avoid unnatural posture and maintain balance at all times. Wear work shoes to increase their stability.
- Do not vacuum any flammable gases or materials (such as paint or paint mist) or any metallic parts.
- Before further use of the machine, the protective devices or slightly damaged parts must be checked carefully for their proper and proper function.
- Damaged safety devices and parts must be properly repaired or replaced by a recognized specialist workshop or by the manufacturer, unless otherwise stated in the operating instructions.
- Switch off the device and disconnect the mains plug from the socket during repair work, maintenance, cleaning and replacement of the chip bag.
- Only use original spare parts

2.7 Safety measures when dealing with electricity

Please note the following:



DANGER!

The extraction system is subject to the conditions for electrical equipment. These must be checked for electrical safety at regular, recurring intervals by a recognized electrician. The test cycles depend on the applicable regulations.

To protect yourself against electric shock, have the machine connected to a suitable and secure electrical outlet only by a qualified electrician.

- Do not use the extraction system if the switch does not allow the machine to be switched on or off properly and if the control components do not reach their proper operating condition.
- Protect the power cord from heat, oil and sharp edges.
- Replace a damaged power cord immediately.
- The plug of the connection cable must be splash-proof.
- The plugs on connection cables must be made of rubber, non-rigid PVC or other thermoplastic material with the same mechanical stability or covered with this material.
- When laying the power cord, make sure it is not squashed, bent, or wet.
- Unwind the cable completely when using a cable drum.
- Periodically check the extension cords and replace them if they are damaged.
- Do not use defective connection cables.
- Do not make temporary electrical connections.
- Never bypass or deactivate protective devices.
- Only connect the machine with a residual current device (30 mA).

2.8 Safety measures for the use of tools

Please note the following:

1. Only use chip bags that are not damaged.
2. Use only original Holzstar filter bags.
3. Immediately replace damaged filter bags. Until replacement of the filter bag, the use of the machine is prohibited.
4. Always use new chip and filter bags.

2.9 Safety measures for processing



DANGER!

Use the machine only for performing normal work.

1. Do not use the machine for purposes for which it is not intended.
2. Do not overload the extraction system. She works better and safer in the specified performance range. Do not use the extraction system for heavy work requiring a more powerful machine.
3. Check the stability of the machine.
4. Note that using tools other than those recommended by the manufacturer and other accessories may result in injury to you.
5. Before turning on, check that all repair and adjustment tools have been removed.
6. This machine is not suitable for receiving hazardous dust.
7. Wear appropriate personal protective equipment if necessary. This could include: hearing protection to avoid the risk of hearing loss; Respiratory protection to avoid the risk of inhaling hazardous dust.
8. Prior to any maintenance and replacement of chips, the extraction system must be secured against start-up.
9. Never reach into the running or currently running device.
10. Ensure good lighting.
11. To avoid contact with the rotating fan, unused exhaust ports should always be covered.
12. When working outdoors, non-slip footwear is recommended.
13. Avoid abnormal posture.
14. Keep the workplace free of wood waste and surrounding parts.
15. All protection and safety features must be reinstalled immediately after repair or maintenance.



Respiratory protection

When changing and emptying the chip bag, wear a dust mask (filter mask with particle filter).

2.10 Safety measures during maintenance and servicing



WARNING!

When carrying out maintenance and repair work always switch off the machine at the main switch and secure it by taking appropriate measures to prevent it being restarted by a third party.

1. After maintenance, repair and cleaning, check that all panels and guards are properly installed on the machine and that there are no more tools inside or in the suction area of the machine.
2. Damaged protective devices, machine parts and switches must be replaced or repaired as intended by a recognized specialist workshop.
3. Make sure that repairs to power tools may only be carried out by a qualified electrician. Only original spare parts may be used. Otherwise, the operator is at risk of accidents.

2.11 Safety check

Check the extraction system regularly.

Check all safety devices

- Before starting work,
- Once a week (during continuous operation),
- After every maintenance and repair.

3 Intended Use

The chip extraction unit is designed and built for use in non-hazardous environments. The extraction system is used to extract chips that are produced when working with wood or wood-like materials. Absorbing metallic or metal-like substances or rocks is not allowed. The device must not be operated in a room for more than half an hour per day due to dust emissions.

The extraction system may only be installed and operated in dry rooms. If the extraction system is used differently than stated above, the extraction system will no longer be used as intended. Non-industrial use is given when no employee, no persons in the vocational training as well as in schools uses the exhaust system.

There is no liability for damages due to improper use. The extraction system has not been designed for commercial, craft or industrial use..



WARNING!

In the event of improper use of the extraction system there are dangers for the personnel, the exhaust system and other assets of the operator are endangered, furthermore the function of the machine may be impaired.

For structural and technical changes to the chip extraction unit, the company Stürmer Maschinen GmbH assumes no liability.

Claims of any kind due to damage due to improper use are excluded.

3.1 Residual risks

If used as intended, residual risks may arise, as well as if the relevant safety regulations are observed due to the design determined by the intended use.

Residual risks can be minimized if the "safety instructions" and the "intended use" as well as the entire operating instructions are observed.

Following these instructions and taking the appropriate care reduces the risk of injury or damage to the device.

- Hearing damage during prolonged work on the machine without ear protection.
- fire hazard
- Electrostatic discharge on the suction hose
- Electric shock hazard through use of non-standard electrical connections.
- Danger from wood dust

4 Description of the device

4.1 Machine

Figures in this operation manual serve to provide a basic under-standing and may differ from the actual design.



Fig. 2: Chip extraction unit SAA 902

- 1 Dust bag hook
- 2 Dust bag
- 3 Quick release dust bag
- 4 Transport handle
- 5 Quick-release device catch bag
- 6 Catch bag
- 7 Base plate
- 8 Chassis
- 9 Suction hose
- 10 Wheel
- 11 Stabilizing sheet
- 12 Plastic housing
- 13 Holes for dust bag hooks
- 14 ON / OFF switch
- 15 Engine

4.2 Scope of supply

- 1 Chip bag and 1 filter sack
- 2 Hose clips and 2 straps
- Hose adapter set 4-part
- 2000 mm PU hose Ø 100 mm

5 Technical Data

5.1 Table

Model	SAA 902
Length	900 mm
Width	500 mm
Height	1550 mm
Weight	19 kg
Supply voltage	230 V
Rated volume flow	1200 m ³ /h
Negative pressure max.	1100 Pa
Extraction duct inlet outside nominal width	100 mm
Extraction duct outlet outside nominal width	100 mm
Electrical data	
Input power	0,55 kW
Output power	0,35 kW
Sound power level max.	94,9 dB(A)
Sound pressure level max.	80,2 dB(A)

5.2 Type plate

Späne-Absauganlage Dust collector			
Type	SAA 902	Serien-Nr. Serial no.	
Artikel-Nr. Item no.	5923902	Baujahr Year of manufacture	
Motorleistung Motor power	550 W	Netzanschluss Power connection	230 V / 50 Hz
Luftleistung Air performance	1200 m ³ /h	Stutzen Eingang Nozzle inlet	Ø 100 mm
Gewicht Weight	19 kg	Stutzen Abgang Nozzle outlet	1x Ø 100 mm
holzstar www.holzstar.de		Stürmer Maschinen GmbH Dr.-Robert-Pfleger-Str. 26, 96103 Hallstadt Deutschland / Germany	

Fig. 3: Type plate SAA 902

5.3 Accessories



Tips and recommendations

We recommend to use only high quality original Holzstar accessories. Only with original accessories, a flawless operation and optimal work results can be guaranteed.

Description	Item number
Filter bag SAA 902	5930903
Chip bag SAA 902 (1 pack of 10 pieces)	5930904
Adapter set for SAA 902	5930905
Reducing socket, not flanged, Ø 100 mm wide, 60 mm narrow	5142427
Floor cleaning set BRS 1	5148100

6 Transport, packaging, storage

6.1 Delivery and transport

Delivery

Check the Chip Extraction Unit for visible transport damage upon delivery. In case of visible damage to the Chip Extraction Unit, immediately notify the carrier or your retailer.

Transport



CAUTION!

Injuries caused by parts falling over or off a forklift, pallet truck or transport vehicle.

Only use means of transport that can carry the total weight and are suitable for it.

Improper transport of individual devices, unsecured devices stacked on top of each other or next to each other in packed or already unpacked condition is accident-prone and can cause damage or malfunctions for which we do not grant any liability or guarantee.

Transport the scope of delivery secured against shifting or tilting with a sufficiently dimensioned industrial truck to the installation site.

General risks during internal transport



CAUTION: DANGER OF TIPPING!

The device may be lifted unsecured by a maximum of 2cm.

Employees must be outside the danger zone, the reach of loads. Warn employees and, if necessary, advise employees of the hazard.

Devices may only be transported by authorized and qualified persons. Act responsibly during transport and always consider the consequences. Refrain from daring and risky actions.

Gradients and descents (e.g. driveways, ramps and the like) are particularly dangerous. If such passages are unavoidable, special caution is required.

Before starting the transport check the transport route for possible danger points, unevenness and disturbances as well as for sufficient strength and load capacity.

Danger points, unevenness and disturbance points must be inspected before transport. The removal of danger spots, disturbances and unevenness at the time of transport by other employees leads to considerable dangers.

Careful planning of internal transport is therefore essential.

6.2 Packaging

All of the Chip Extraction Unit's packaging materials and packing aids are suitable for recycling and must always be disposed of using material-based recycling systems.

Packaging materials made of cardboard must be shredded and recycled as waste paper.

The foils are made of polyethylene (PE), padding is made of polystyrene (PS). Dispose of these substances at a recycling centre or hand them over to a qualified waste disposal company.

6.3 Storage

The chip extraction unit must be thoroughly cleaned and stored in a dry, clean and frost-free environment. Cover the machine with a tarpaulin.

6.4 Installation and connection

6.5 Requirements to the installation location

Remove the chip extraction unit from its packaging and remove all protective foils.

To achieve a good function and a long life of the Chip Extraction Unit, the installation location should satisfy the following criteria:

- The substrate must be level, firm and vibration-free.
- The installation or working room must be dry and well ventilated.
- Do not install or operate the machine in damp or wet conditions. The humidity should not exceed 90% and the measured ambient temperature should be between -10 ° C and + 50 ° C.
- There must be sufficient space for the operating personnel, for material transport as well as for adjustment and maintenance work.
- Mains voltage and frequency should correspond to the characteristics of the motor of the machine.
- The site must have good lighting.

6.6 Assembly of the extraction system



Wear safety glasses!



Wear safety shoes!



Wear protective clothing!



DANGER!

Before all maintenance conversion and installation work on the exhaust system, the mains plug must be disconnected!

Step 1: Remove the packaging and check the machine for completeness.

Step 2: Attach the wheels and the two side panels to the bottom of the chassis using the M8x40 square head bolts and nuts (Fig.4).

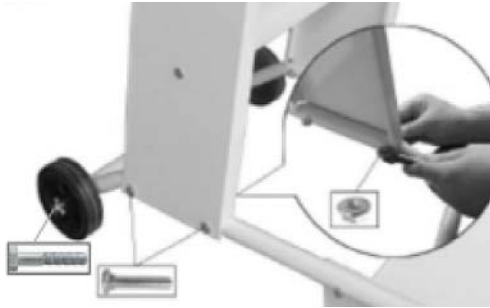

Fig. 4: Mount wheels and side plate

Step 3: Screw the cross plate (4, Fig.5) tight with the M8x10 square head screws.

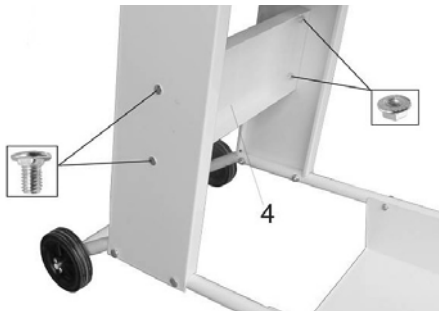

Fig. 5: Mounting side panels

Step 4: Lay the preassembled unit on its side and screw the two sides of the chassis together with the M5x16 cheese head screws and M5 hex nut (Fig.6).

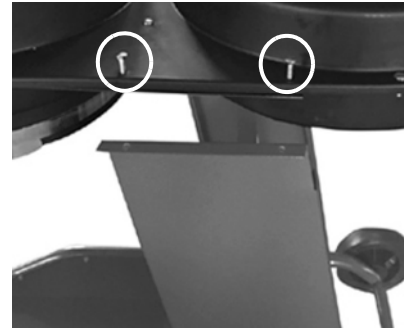
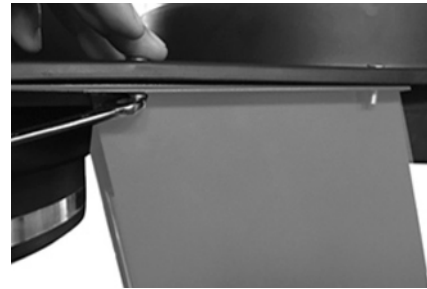

Fig. 6: Mounting device unit



Step 5: Insert a hose fitting (17) over the suction hose (7) as far as it will go to the suction connection of the device and fix it with the hose clamp according to fig. 7.

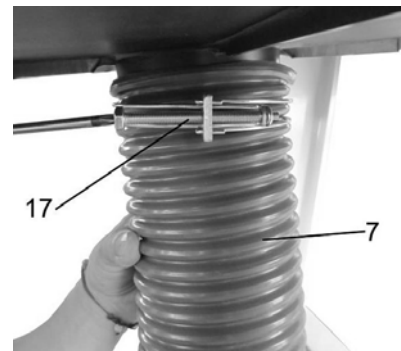

Fig. 7: Hose fitting

Step 6: Pull the chip bag (6) over the lower opening of the plastic housing (13) so that it completely closes the opening and secure it with the quick release device (3) Fig. 8.

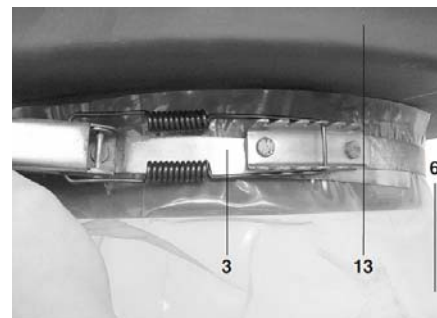

Fig. 8: Quick release device catch bag

Step 7: Insert the dust bag hook (1) into the hole (14) on the plastic housing (13) and hook the dust bag (2) onto the dust bag hook (Fig. 9).

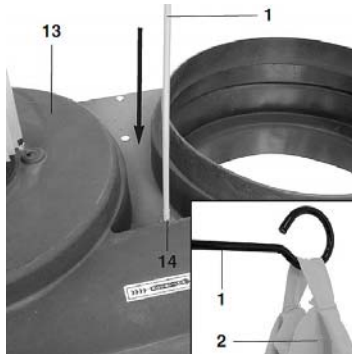

Fig. 9: Mounting dust bag hook

Step 8: Put the dust bag (15) over the upper opening of the plastic housing so that it completely surrounds the opening and secure it with the quick release device (Fig. 10).

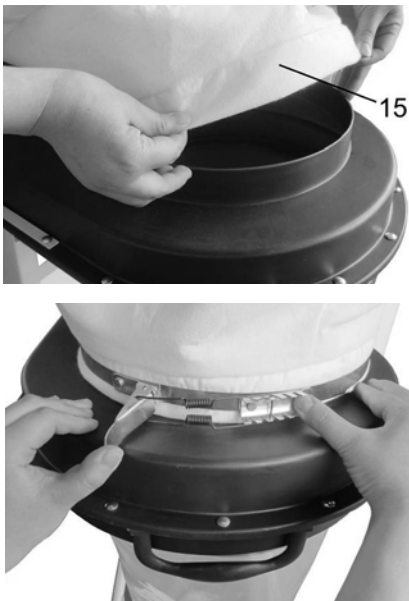

Fig. 10: Dust bag and quick release device

Step 9: If devices with a suction connection diameter of 100mm are to be connected to the extraction system, insert a hose attachment (A) over the suction hose (11). Now insert the connection adapter (18) as far as it will go into the suction hose (11) and secure it by tightening the sluice attachment (A).

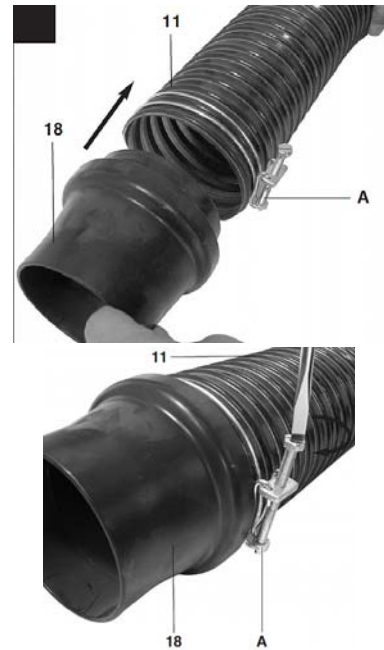

Fig. 11: Connection adapter

6.7 Setting up the chip extraction unit

Place the machine on a stable, level surface. The distance to the wall should be at least 800 mm. Check your electrical connection voltage. This must be with the voltage match the machine.

Do not expose the machine to moisture, rain or snow. Maintain the machine regularly.



CAUTION!

Risk of injury due to a machine that is not stably erected!

Check the stability of the machine after placing it on stable ground.



Wear safety gloves!



Wear protective clothing!



Wear safety shoes!

6.8 Commissioning of the chip extraction unit

- Step 1: Check if the suction hose is firmly connected to the extraction unit and to the extraction adapter of the woodworking machine.
- Step 2: Check if the chip bag is well fastened.
- Step 3: Turn on the exhaust system first, then the woodworking machine.
- Step 4: Turn off the woodworking machine before shutting down the vacuum system.
- Step 5: Check the chip collecting bag regularly and empty it.
- Step 6: Before operating the on / off switch, make sure that the filter bag is securely fastened.

6.9 Electrical connection



DANGER!

Observed on the good grounding of the Extraction Unit!

Static electricity charge leads to

- Deposition of abrasive dust
- Rapid corrosion of the moving parts.
- Spark formation by discharge with explosion hazard!



DANGER!

Danger to life due to electrical shock!

There is an immediate danger of electrocution on contact with live components.

- The extraction system may only be connected by qualified electricians.
- Work on the electrical system should only be carried out by qualified electricians.

Connect the exhaust system to the mains in the following steps:

- Step 1: The extraction system must be switched off.
- Step 2: Connect the exhaust system to a 230 V safety socket (FI switch 30mA). Use only connecting cables with sufficient diameter. (Main fuse 10 A).
- Step 3: Check that all safety devices are mounted.
- Step 4: Turn on the system.
- Step 5: Check that the direction of rotation of the motor is correct.

6.10 Static charge

Due to friction in the suction hose, a static charge can occur.

To prevent sparks from causing a dust explosion or fire, the static charge must be dissipated via the grounding. For this purpose, it is recommended that a suction hose with metal wire is used. The ends of the metal wire are then connected to the conductive housing of the extraction system and the machine to be extracted.

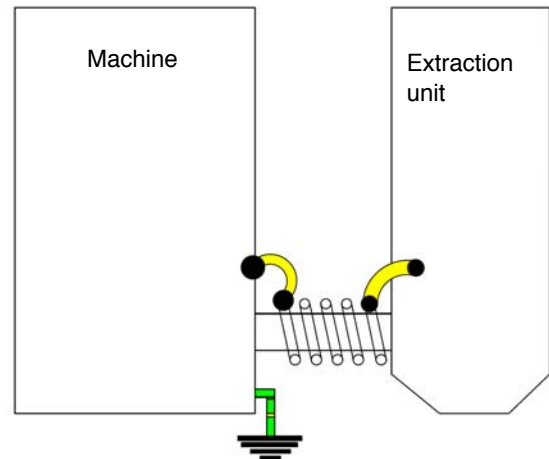

Fig. 12: Connection machine and exhaust system

7 Operation

7.1 Switch on

- Check that the suction hose is firmly connected to the extraction unit and to the extraction adapter of the woodworking machine.
- Check if the chip bags are well fastened.
- Switch on the extraction system by pressing the green button "I"
- Turn on the woodworking machine.

7.2 Switch off

- Switch off the woodworking machine
- Exhaust system by pressing the red button "O"
- or switch off by pressing the emergency stop button.

7.3 Emptying the chip collecting bag

- Check and empty the chip collecting bag regularly.
- ATTENTION: Pull out the mains plug!
- Hold the filled chip bag with one hand.
- Open the quick release device.
- Remove the bag and dispose of the contents in an environmentally friendly way.
- Put the bag back on the holder and fix it with the quick release device.

7.4 Transport of the extraction system

The extraction system has a standard chassis. To transport the extraction system, slightly lift the transport handle (4) (Fig. 12) and move it to the desired location.



Fig. 13: Chassis

8 Care, maintenance and repair



Tips and recommendations

The Chip Extraction Unit is constructed for efficient operating. To guarantee a long life the servicing aspects are to be carried out regularly.



DANGER!

Danger to life due to electrical shock!

Danger of live through electric shock by contact with live power components!

- The Chip Extraction Unit may connected only from Qualified electrician.
- Repairs on the electrical system must execute only from Qualified electrician.
- Switch off the machine and pull the plug out before starting any cleaning or maintenance work.



WARNING!

Risk from inadequately qualified persons!

Inadequately qualified persons are unable to assess the risks when handling the machine, thus putting themselves and others at risk of severe injuries.

All work must be carried out by qualified persons only.



NOTE!

After servicing, repair or cleaning please check whether all protective devices are mounted properly again, and no more tools are left inside the machine. Damaged safety devices, machine parts and counters must be exchanged in accordance with the requirements by an approved professional workshop.

Daily Service

- Clean the machine after every use.
- Replace damaged security devices immediatel.



Wear safety gloves!

Weekly Service

- Clean the machine regularly with a damp cloth and some soft soap. Do not use detergents or solvents; these could attack the plastic parts of the machine. Make sure that no water can get inside the machine.
- Keep the guards, air vents and motor housings as dust and dirt free as possible. Wipe the machine with a clean cloth or blow it out with compressed air at low pressure.
- When changing and emptying the chip bag, wear a dust mask.

Monthly Service

- Control fixing bolts of the machine.

Service after 6 month

- Check electric and safety devices

8.1 Cleaning



DANGER!

Before all maintenance conversion and cleaning work on the exhaust system, the mains plug must be disconnected!

Cleaning instructions at the extraction system

- Do not spray motor and switch directly with a jet of water and clean.
- Wear a dust mask when cleaning
- (Particulate Filter - Filter Class 2).
- Clean the electric motor and circuit breaker with a dry cloth only.
- Dump the dust bag before changing it

9 Troubleshooting



DANGER!

If one of the following malfunctions occurs, immediately stop working with the machine. Before you start troubleshooting, turn off the machine and unplug the power plug. Failure to do so can lead to serious injury. All repairs or replacement work may be performed by qualified and trained expert staff only.

Fault	Possible cause	Remedy
Machine does not start	<ol style="list-style-type: none"> 1. Power plug is not plugged in. 2. Power supply cables defective. 3. Switch defective 4. Motor defective 	<ol style="list-style-type: none"> 1. Plug in the power plug 2. Call a service technician 3. Call a service technician 4. Call a service technician
Strong vibrations	<ol style="list-style-type: none"> 1. Loose component 2. Motor support is brocked. 3. Motor bearing is used up 	<ol style="list-style-type: none"> 1. Check all connections, tighten bolts and nuts. 2. Replace the motor support 3. Replace the motor bearding
Poor extraction	<ol style="list-style-type: none"> 1. Dust container is full 2. Filter is blocked 3. The Extraction Unit is under sized 4. The extraction line is too long 	<ol style="list-style-type: none"> 1. Empty the dust container. 2. Clean the filter. 3. Use The extraction line with Ø larger than 100 mm. 4. Set the Extraction Unit near on the woodworking machine

10 Disposal, reusing used machines

To protect the environment make sure that all machine components are exclusively disposed of as intended and legally permitted.

10.1 Decommissioning

Disused machines must be decommissioned immediately to prevent unintended use at a later point and putting the environment or persons at risk.

Step 1: Remove all environmentally hazardous fluids from the old machine.

Step 2: If necessary, dismantle the machine into manageable and usable assemblies and components.

Step 3: Guide the machine components and operating materials to the appropriate disposal routes.

10.2 Disposal of electrical equipment

Please note that electrical appliances contain a variety of recyclable materials as well as environmentally harmful components. Make sure that these components are disposed of separately and properly. In case of doubt, please contact your municipal waste disposal. If necessary, the help of a specialized waste disposal company can be used for the treatment.

10.3 Disposal via municipal collection points

Disposal of used electrical and electronic equipment (Applicable in the countries of the European Union and other European countries with a separate collection system for these appliances).



The symbol on the product or its packaging indicates that this product should not be treated as normal household waste, but must be returned to a collection point for the recycling of electrical and electronic equipment. By helping to properly dispose of this product, you are protecting the environment and the health of others. Environment and health are endangered by improper disposal. Material recycling helps to reduce the consumption of raw materials. For more information about recycling this product, contact your local community, municipal waste management, or the shop where you purchased the product.

11 Spare parts



DANGER!

Risk of injury caused by the use of incorrect spare parts!

The use of incorrect or faulty spare parts may cause risks for operating staff and damage as well as malfunctions.

- Exclusively genuine spare parts made by the manufacturer or spare parts authorised by the manufacturer shall be used.
- Always contact the manufacturer if you are unsure.



NOTE!

Using non-approved spare parts voids the manufacturer's warranty.

11.1 Ordering spare parts

The spare parts can be obtained from the dealer or directly from the manufacturer. The contact details are listed in chapter 1.2 Customer Service.

Please provide the following key data for inquiries or when ordering spare parts:

- Device type
- Serial number
- Quantity
- Designation
- Desired shipping type (post, freight, sea, air, express)
- Shipping address

Spare parts orders without the aforementioned data cannot be taken into account. The supplier shall determine the shipping type if no relevant data was provided.

Information on the device type, article number and year of manufacture can be found on the type plate attached to the device.

Example

The engine for the Chip extraction unit SAA 902 must be ordered. The engine has the number 11 in the spare parts drawing 1.

By ordering spare parts, send a copy of the spare parts drawing (1) with the marked part (engine) and marked position number (11) to the dealer or spare parts department and provide the following information:

- Type of device: **Chip extraction unit SAA 902**
- Item number: **5923902**
- Drawing number: **1**
- Position number: **11**

11.2 Spare parts drawing

The following drawing are intended to help identify the necessary spare parts. To order, please send a copy of the part drawing with the marked components to your dealer.

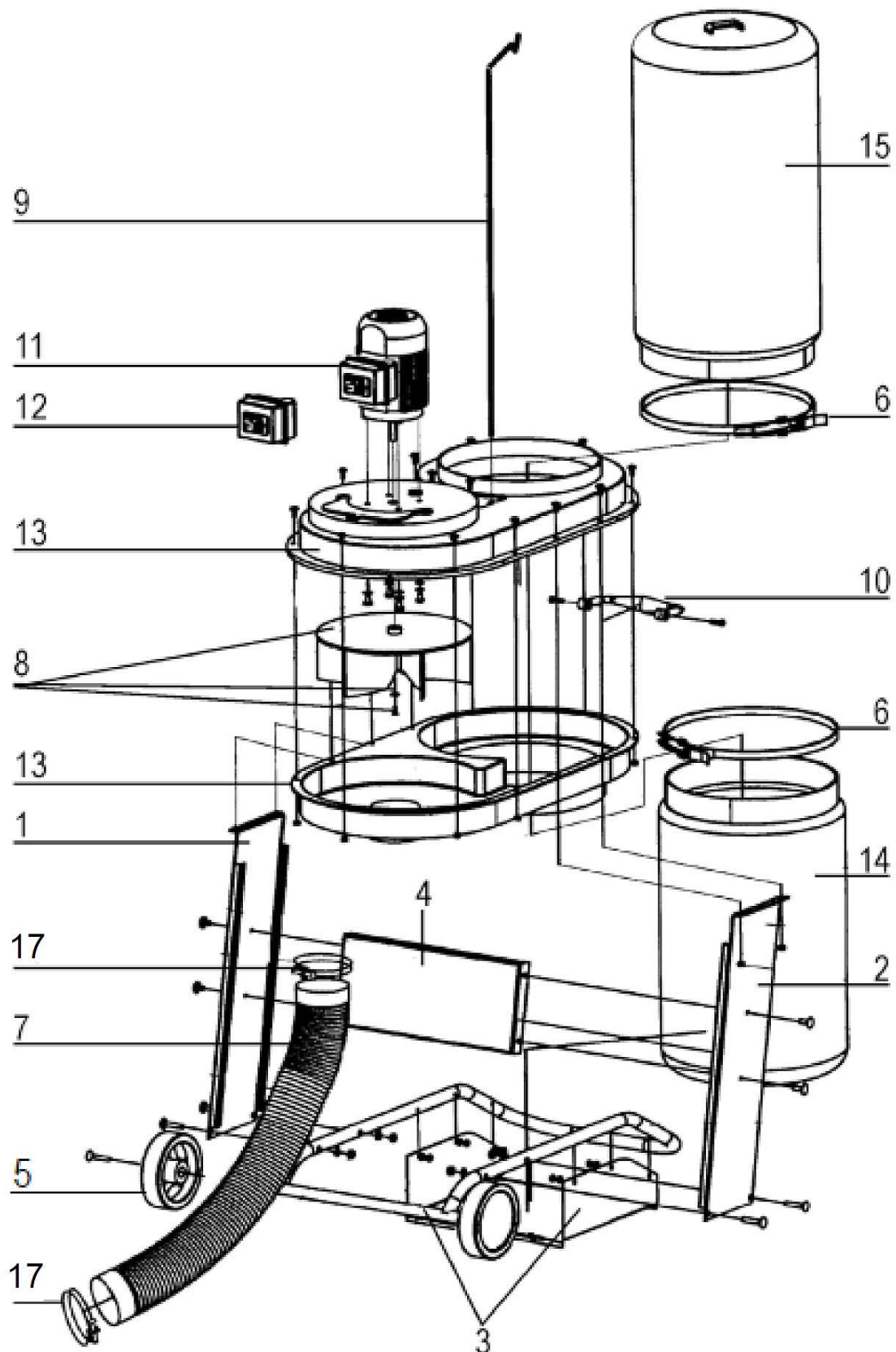

Fig. 14: Spare parts drawing SAA 902

12 Electrical schematic

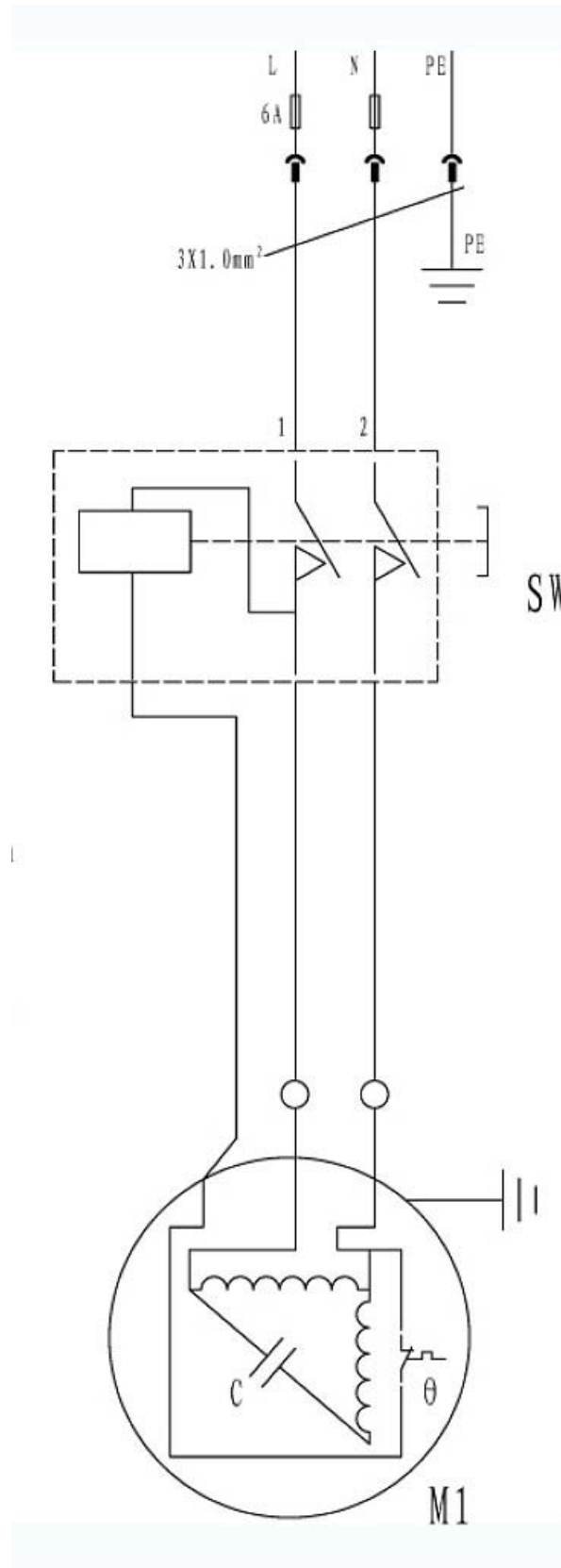

Fig. 15: Wiring Diagram SAA 902

13 EC - Declaration of Conformity

As per machine directive 2006/42/EC, Appendix II 1.A

Manufacturer / Distributor: Stürmer Maschinen GmbH
Dr.-Robert-Pfleger-Str. 26
D-96103 Hallstadt

hereby declares that the following product

Product group: Holzstar® Wood working machines

Machine type: Chip extraction unit

Description of the Machine: SAA 902

Item number: 5923902

Serial number*: _____

Year of manufacture*: 20____

* please fill in according to the information on the type plate

corresponds, on the basis of its design and construction, as well as the version that we have put into circulation, with the relevant fundamental health and safety requirements of (subsequent) EU Directives.

Relevant EU Directives:

2014/30/EU	EMC-Directive
2011/65/EU	RoHS-Directive
2012/19/EU	WEEE-Directive

The following harmonized standards have been applied:

DIN EN 60335-1:2012+A11	Household and similar electrical appliances - Safety - Part 1: General requirements
DIN EN 60335-2-69:2012	Household and similar electrical appliances - Safety - Part 2-69: Particular requirements for wet and dry vacuum cleaners, including power brush for commercial use
DIN EN 62233:2008	Measurement methods for electromagnetic fields of household appliances and similar apparatus with regard to human exposure
DIN EN 55014-1:2017	Electromagnetic compatibility - Requirements for household appliances, electric tools and similar apparatus - Part 1: Emission
DIN EN 55014-2:2015	Electromagnetic compatibility - Requirements for household appliances, electric tools and similar apparatus - Part 2: Immunity - Product family standard
DIN EN 61000-3-2:2019	Electromagnetic compatibility (EMC) - Part 3-2: Limits - Limits for harmonic current emissions (equipment input current ≤ 16 A per phase)
DIN EN 61000-3-3:2013	Electromagnetic compatibility (EMC) - Part 3-3: Limits - Limitation of voltage changes, voltage fluctuations and flicker in public low-voltage supply systems, for equipment with rated current ≤ 16 A per phase and not subject to conditional connection

Responsible for documentation: Kilian Stürmer, Stürmer Maschinen GmbH,
Dr.-Robert-Pfleger-Str. 26, D-96103 Hallstadt
Hallstadt, 16.12.2019



Kilian Stürmer
Manager



