



ZIPPER MASCHINEN GmbH

Gewerbepark 8

4707 Schlüsslberg | AUSTRIA

+43 (0) 7248 61116-700 | FAX 7248 61116-720

info@zipper-maschinen.at | www.zipper-maschinen.at

Originalfassung

DE BETRIEBSANLEITUNG

Übersetzung / Translation

EN USER MANUAL

KOMPRESSOR

AIR COMPRESSOR



ZI-COM30-10

EAN: 9120039233574



ZI-COM50-10

EAN: 9120039232935





11 PREFACE (EN)

Dear Customer!

This manual contains important information and advice for the correct and safe use and maintenance of the air compressor ZI-COM30-10 and ZI-COM50-10.

Following the usual commercial name of the device (see cover) is substituted in this manual with the name "machine".

The manual is part of the machine and may not be stored separately. Read it profoundly before first use of the machine and keep it for later reference. When the machine is handed to other persons always put the manual to the machine.

Please follow the security instructions!

Please read the entire manual, to prevent misunderstandings, machine damage or even injuries!



Due to continuous development of our products illustrations, pictures might differ slightly.

If you however find errors in this manual, please inform us.

Technical changes excepted!

Copyright law

© 2018

This manual is protected by copyright law – all rights reserved. Especially the reprinting as well as the translation and depiction of pictures will be prosecuted by law. Court of jurisdiction is the Landesgericht Linz or the competent court for 4707 Schlüsslberg, AUSTRIA.

Customer Support

ZIPPER MASCHINEN GmbH

Gewerbepark 8, 4707 Schlüsslberg
AUSTRIA

Tel.: +43 7248 61116-700

Fax: +43 7248 61116-720

Mail: info@zipper-maschinen.at



12 SAFETY

12.1 Intended Use

The machine must only be used for its intended purpose! Any other use is deemed to be a case of misuse. To use the machine properly you must also observe and follow all safety regulations, the assembly instructions, operating and maintenance instructions lay down in this manual.

All people who use and service the machine have to be acquainted with this manual and must be informed about the machine's potential hazards.

It is also imperative to observe the accident prevention regulations in force in your area.

The same applies for the general rules of occupational health and safety.

The machine is used for:

Generating compressed air for tools operated by compressed air.

Any manipulation of the machine or its parts is a misuse, in this case ZIPPER-MASCHINEN and its sales partners cannot be made liable for ANY direct or indirect damage.



WARNING

Using compressed air equipment and tools

Please pay attention to the air consumption with the respective manufacturer. Check the performance of your compressor if the power is enough!

Ambient conditions

The machine may be operated:

humidity	max. 70%
temperature	+5°C to +40°C (+41°F to +104°F)

The machine shall not be operated in areas exposed to increased fire or explosion hazard.

Prohibited use:

- The operation of the machine outside the stated technical limits described in this manual is forbidden.
- The operation of the machine without provided protective devices is prohibited
- Any manipulation of the machine and parts is forbidden.
- The use of the machine not being suitable for the use of the machine and not being certified is forbidden.
- The operation of the machine without provided protective devices is prohibited.
- The use of the machine for any purposes other than described in this user-manual is forbidden.
- The unattended operation on the machine during the working process is forbidden!
- It is not allowed to leave the immediate work area during the work is being performed.
- The machine has not been designed for use in commercial, trade or industrial applications. Use the machine only in try areas.
- To aim the compressed air gun at persons is prohibited.



12.2 Security instructions

Missing or non-readable security stickers have to be replaced immediately!

The locally applicable laws and regulations may specify the minimum age of the operator and limit the use of this machine!

To avoid malfunction, machine defects and injuries, read the following security instructions!

- **Keep your work area dry and tidy! An untidy work area may cause accidents. Avoid slippery floor!**
- **Make sure the work area is lighted sufficiently!**
- **Work only in a well ventilated area!**
- **Do not overload the machine!**
- **Always stay focused when working. Reduce distortion sources in your working environment. The operation of the machine when being tired, as well as under the influence of alcohol, drugs or concentration influencing medicaments is forbidden!**
- **Only one person shall operate the machine**
- **The machine must be operated only by trained persons (knowledge and understanding of this manual), which have no limitations of motor skills compared with conventional workers.**
- **Do not allow other people, particularly children, to touch the machine or the cable. Keep them away from your work area**
- **Make sure there is nobody present in the dangerous area. The minimum safety distance is 2m**
- **Use personal safety equipment: ear protectors, safety goggles and work wear when working with or on the machine!**
- **The plug of an electrical tool must strictly correspond to the socket. Do not use any adapters together with earthed electric tools**
- **Each time you work with an electrically operated machine, caution is advised! There is a risk of electric shock, fire;**
- **Protect the machine from dampness (causing a short circuit)**
- **When working with the machine outdoors, use extension cables suitable for outdoor use**
- **Use power tools and machines never in the vicinity of flammable liquids and gases (danger of explosion)**
- **Check the cable regularly for damage**
- **Do not use the cable to carry the machine or to fix the work piece**
- **Protect the cable from heat, oil and sharp edges**
- **Avoid body contact with earthed components**
- **Never leave the machine running unattended! Before leaving the working area switch the machine off and wait until the machine stops.**
- **Always disconnect the machine prior to any actions performed at the machine.**
- **Avoid unintentional starting**
- **Do not use the machine with damaged switch**
-

Safety instructions when working with compressed air guns

- Compressor pump and lines reach high temperatures during operation. Touching cause burns
- When removing the hose coupling, hold the coupling piece of the hose is by hand. So the injury from rebounding hose is avoided



Safety instructions when paint spraying

- Do not process paints or solvents with a flash point of less than 55 ° C.
- Do not heat paints and solvents.
- If harmful liquids processed use dust masks. Note the instructions on protective measures made by the manufacturers of such substances.
- During the paint spraying process and in the work space may not be smoked. Even paint fumes are highly inflammable.
- In working area smoking and open flames are forbidden during paint spraying.
- Do not keep or consume food and drinks in the working area. Paint fumes are harmful.
- Work only in a well ventilated area that is bigger than 30m³. Do not spray against wind direction. Note the local regulations.
- Do not process white spirit, butyl alcohol and methylene chloride when use PVC hoses because lifetime will substantially reduces

Operation of pressure vessels

- Anyone who operates a pressure vessel has this to get in proper condition, operate it properly, monitor, make any necessary maintenance and repair work without delay and to meet the circumstances necessary security measures.
- A pressure vessel may not be operated if it has defects or will endanger employees or third persons.
- The pressure vessel must be regularly checked for damage such rust,.

13 ASSEMBLY

Please check the product contents immediately after receipt for any eventual transport damage or missing parts. Claims from transport damage or missing parts must be placed immediately after initial machine receipt and unpacking before putting the machine into operation. Please understand that later claims cannot be accepted anymore.

13.1 Assembly

Wheels:

Mount the wheels like on the picture

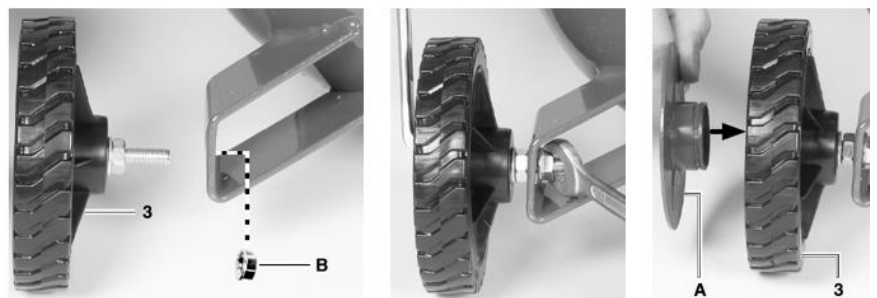

Rubber foot:

Mount the rubber foot like on the picture

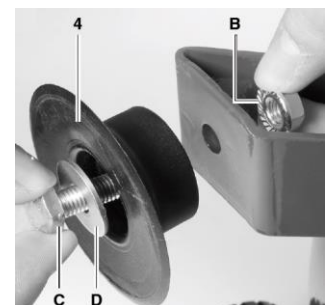



14 OPERATION

Device to be operated in a perfect state only. Inspect the device visually every time it is to be used. Check in particular the safety equipment, electrical controls, electric cables and screwed connection for damage and if tightened properly. Replace any damaged parts before operating the device.

14.1 Operation instructions

	WARNING	
	Perform all machine settings with the machine being disconnected from the power supply!	

	NOTICE
	<ul style="list-style-type: none">• The machine should be set up near the working consumer. Avoid long air lines and long supply lines (extensions).• Make sure the intake air is dry and dust-free.• Do not set up the machine in damp or wet areas.• The machine must be operated on firm, level ground• When removing the hose coupling, hold the coupling piece of the hose is by hand. So the injury from rebounding hose is avoided

14.2 Operation

Switch on:

Push the ON-OFF-switch "1"

Switch off:

Push the ON-OFF-switch "0"

Setting output pressure:

The output pressure can be set with the pressure regulator

Output pressure:

The output pressure is shown on the manometer output pressure

Pressure switch adjustin:

The pressure switch is set at the factory.

Starting pressure ca. 8 bar

Stoping pressure ca. 10 bar

Before use, check whether the compressor switches off when the switch-off pressure is reached.

Afterwards, check the pressure of the compressed air by means of a compressed air tool to ensure that the compressor starts up again when the pressure is reduced

Output:**Only perform in a pressure-free state**

To connect a device place the union joint into the coupling. The sleeve will go to starting position automatically. To disconnect pull the sleeve backwards and remove the hose.



15 MAINTENANCE



ATTENTION

Bevor maintenance:

- **Switch off and disconnect from the power supply!**
- **Let cool down the air compressor!**
- **Depressurize the air tank**

The machine does not require intense maintenance. However, to ensure a long lifespan, we strongly recommend following the upkeep and maintenance plan.

Repairs must be carried out by specialists! Use original ZIPPER parts only!

NOTICE

Only a properly maintained equipment may be a satisfactory tool. Care and maintenance deficiencies can cause unpredictable accidents and injuries.

Repairs should be performed only by authorized service centers.

Improper operation may damage the equipment or endanger your safety.

15.1 Cleaning

Keep the safety devices free of dirt and dust as far as possible. Wipe the machine with a clean cloth or blow it with compressed air at low pressure.

NOTICE

Do not use cleaning agents or solvents; these could attack the plastic parts of the machine!

Put on all coatless flats a thin coat of oil.

15.2 Maintenance plan

Controls for the maintenance of the machine	
Loose or lost screws, nuts, bolts	Regularly prior to each operation
Damage of any part of the machine	Regularly prior to each operation
Machine cleaning	Regularly after operation
Air filter cleaning	Every 20-30 working hours

15.2.1 Condensation water

To ensure a long service life of the pressure vessel, drain off the condensed water by opening the drain screw each time after using. Take care to perform only with max. 1bar pressure.

Check the pressure vessel for rust and damage before each operation. The compressor must not be operated with a damaged or rusty pressure vessel. If any damage is found, please contact the customer service center.

15.2.2 Storage

If the machine is stored for longer than 30 days:

- Let the machine cool down
- Clean the machine and dry
- Depressurize the air tank.
- Store in a dry, out of reach of children place, well packaged (protection against cuts)

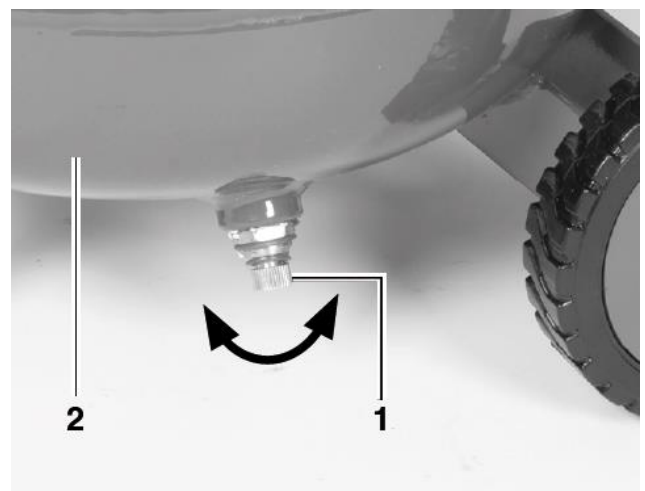



15.3 Disposal

Do not dispose the machine, machine components fuel and oil in residual waste. Contact your local authorities for information regarding the available disposal options. When you buy at your local dealer for a replacement unit, the latter is obliged to exchange your old.



16 TROUBLE SHOOTING

Disconnect the machine from the power supply prior to any checks performed at the machine itself!

Trouble	Possible cause	Solution
Pressure can no longer be stored	<ul style="list-style-type: none"> • Valve seals broken 	<ul style="list-style-type: none"> • Replace the seals
Compressor runs but produces no pressure	<ul style="list-style-type: none"> • Defective seals • Defective valves 	<ul style="list-style-type: none"> • Replace the seals • Replace the valves
Engine will not start	<ul style="list-style-type: none"> • No power supply 	<ul style="list-style-type: none"> • Check the connection to an existing electrical grid.
After reaching the escapes cut-off pressure Compressed air through the relief valve und Pressure switch to reach the starting pressure	<ul style="list-style-type: none"> • Leaking or defective check valve • Check valve is damaged 	<ul style="list-style-type: none"> • Clean or replace check valve insert • Replace check valve
Compressor on frequently	<ul style="list-style-type: none"> • Very much condensate in the pressure boiler • Overload compressor 	<ul style="list-style-type: none"> • Drain condensate

MANY POTENTIAL SOURCES OF ERROR CAN BE CLEARED BY THE EXPERTLY CONNECTION TO THE ELECTRICITY GRID.

	NOTICE
	Should you in necessary repairs not able to properly to perform or you have not the prescribed training for it always attract a workshop to fix the problem.