



ZIPPER MASCHINEN GmbH

Gewerbepark 8
4707 Schlüsslberg | AUSTRIA
+43 (0) 7248 61116-700 | FAX 7248 61116-720
info@zipper-maschinen.at | www.zipper-maschinen.at

Originalfassung

DE BETRIEBSANLEITUNG

MOTORSENSE

Übersetzung / Translation

EN USER MANUAL

BRUSH CUTTER

HU HASZNÁLATI UTASÍTÁS

MOTOROS KASZA

SL NAVODILA ZA UPORABO

MOTORNA KOSA

HR UPUTA ZA UPORABU

MOTORNA KOSA

FR MANUEL D'UTILISATION

DÉBROUSSAILLEUSE



ZI-MOS145JAK

EAN: 9120039233208





10 PREFACE (EN)

Dear Customer!

This manual contains important information and advice for the correct and safe use and maintenance of the brush cutter ZI-MOS145JAK.

Following the usual commercial name of the machine (see cover) is substituted in this manual with the name "machine".

The manual is part of the machine and may not be stored separately. Read it profoundly before first use of the machine and keep it for later reference. When the machine is handed to other persons always put the manual to the machine.

Please follow the security instructions!

Please read the entire manual, to prevent misunderstandings, machine damage or even injuries!



Due to continuous development of our products illustrations, pictures might differ slightly.

If you however find errors in this manual, please inform us.

Technical changes excepted!

Copyright law

© 2018

This manual is protected by copyright law – all rights reserved. Especially the reprinting as well as the translation and depiction of pictures will be prosecuted by law. Court of jurisdiction is the Landesgericht Linz or the competent court for 4707 Schlüsslberg, AUSTRIA.

Customer Support

ZIPPER MASCHINEN GmbH

Gewerbepark 8, 4707 Schlüsslberg
AUSTRIA

Tel.: +43 7248 61116-700

Fax: +43 7248 61116-720

Mail: info@zipper-maschinen.at



11 SAFETY

11.1 Intended Use

The machine must only be used for its intended purpose! Any other use is deemed to be a case of misuse.

To use the machine properly you must also observe and follow all safety regulations, the assembly instructions, operating and maintenance instructions lay down in this manual.

All people who use and service the machine have to be acquainted with this manual and must be informed about the machine's potential hazards.

It is also imperative to observe the accident prevention regulations in force in your area.

The same applies for the general rules of occupational health and safety.

The machine is used for:

Mowing and trimming grass at moderate and non-slippery terrain and for cutting twigs and hedges.

Any manipulation of the machine or its parts is a misuse, in this case ZIPPER-MASCHINEN and its sales partners cannot be made liable for ANY direct or indirect damage.



WARNING

- **Do not change the mowing attachment!**
- **Damaged cutting tools may be not straightened or welded in no case
HIGHEST RISK OF INJURY!**

11.2 Safety instructions

Missing or non-readable security stickers have to be replaced immediately!

To avoid malfunction, machine defects and injuries, read the following security instructions!

The locally applicable laws and regulations may specify the minimum age of the operator and limit the use of this machine!

- Use the machine only in good enough light to allow a safe operation can be guaranteed.
- In tiredness, decreased concentration or under the influence of alcohol or drugs, the work on the machine is prohibited!
- Caution in slippery conditions - slip hazard - risk of injury. When working, robust and non-slip footwear. Slides / stumble / traps are a major cause of serious injury or death.
- The machine may only be operated by trained personnel.
- Unauthorized persons, especially children and not trained personnel must be kept away from the running machine!
- If you pass the machine to third, these instructions must be attached to the machine.
- Before each use, the reliability of the machine is to be checked (tightness of the cutting tool, the proper function of the throttle lever)
- Danger of burns! During the operation flow of hot exhaust gases and engine parts such as the carburettor and engine become hot.
- Never place a hot brush cutter in dry grass or other easily flammable materials.
- After the operation, the machine must cool down. Otherwise there is an imminent risk of burns
- **WARNING:** Gasoline is highly flammable!
- Smoking and open flames are prohibited during refuelling. Do not refuel when the engine and carburettor are still very hot.
- Refuel only outdoors or in a well ventilated area.



- Avoid contact with skin and clothes (fire hazard).
- Check after refuelling tank cap and check for leaks.
- Start the engine at least 3 meters from the tank location.
- Spilled fuel is wipe immediately.
- Work attentively, safety conscious and always be fully aware safe stand when working! Caution on uneven work surfaces and work surfaces with a slope!
- Never cutting:
 - above hip height
 - on a ladder
 - on trees
- Regular breaks reduce the security risk to loss of control due to fatigue. Change the working position over again.
- Avoid abnormal posture.
- At idle, the blade should not rotate!
- The maximum shaft speed must not exceed the specified speed. Checked settings!
- No other person shall remain within 15m!
- This distance also adhere to things! Danger of damage!
- Solid objects, stones, metal parts, or the like can be thrown out - risk of injury!
- Use personal safety equipment: ear protectors, safety goggles, safety shoes and safety helmet when working with the machine
- Never leave the machine running unattended! Before leaving the working area switch the machine off and wait until the machine stops.
- Switch off the machine before maintenance or adjustment.
- Storage always with an empty tank in a safe place.
- Do not grab in the cutting tool while it is rotating.
- Take care that you do not get under the cutting tool!
- Always use the correct cutting tool for the work to be done.
- Do not operate in an enclosed or confined areas.
- Exhaust contains poisonous carbon monoxide. The exposure can cause unconsciousness and death.
- Before the start, after the failure or shock, be sure to check the device and make sure that it is in good condition.
- Wear firm gloves when you use the brush cutter or if you install or remove the cutting blade.

TRANSPORT NOTES:

- Switch off the engine
- Fit the blade guard
- Secure the machine
- Empty tank completely, avoid fuel spillage
- To avoid damage to the device never drag but always lift correctly.

STORAGE NOTES:

- Remove and clean thread head and cutter blade
- Fit the blade guard
- Clean the machine and dry
- Empty Tank completely, avoid fuel spillage
- Store in a dry, out of reach of children place, well packaged (protection against cuts)



11.3 Remaining risk factors

Working with a brush cutter always poses some risks that cannot be eliminated entirely:

- **Noise:** Working for a long time can damage your hearing if you do not have a very good hearing protection.

- **Risks of injury:**

Be aware that the cutter might stall and lead you to fall.

Small objects might be caught by the machine and catapulted into the air.

The contact with the rotating moving cutter causes severe injuries! Protect especially your feet by wearing reinforced security shoes.

Never get with your fingers or hands near the rotating moving cutter.

Do not touch the muffler or other machine components during operation – They become hot!

- **Risk to the hands or fingers:**

Access while it is working in the mowing apparatus. After the operation, the machine must cool down. Otherwise, there is an acute risk of scalding! Wear protective gloves to avoid injury

- **Vibration:**

The declared vibration emission value has been for a standardized test is measured and can be used to compare one tool with another electric are.

The declared vibration emission value may also be used for a preliminary assessment of exposure.

- **Warning:**

Emission level of vibration can be different from the specified value during the actual use of the electric tool, depending on the manner in which the power tool is used

- **Kickback**

When working with metal cutting blades, it can, if fixed objects (trees, branches, stones, or the like) are involved, come to a check of the entire unit or to an abrupt train forward.

This check occurs suddenly without warning and can lead to loss of control of the unit and endanger the user and bystanders.

Special Threatened in poor visibility areas and dense vegetation.

So keep checking by kickback:

- Hold the unit with both hands when working securely.
- Be easily spread on a secure footing and keep your feet always count on you with a possible setback.
- Do not overestimate yourself and keep it in working balance at all times.
- The knife should have reached full operating speed before cutting begins.
- When clearing stones and debris can be thrown and cause serious injury.

Make sure that the cover is securely mounted.

Be rotating parts (blades) mounted incorrectly, this can lead to serious accidents.

Check before starting work, the cutting blade for tight fit



11.4 Personal wear

- A. Security helmet
- B. Hearing protection
- C. Face protection
- D. Belt
- E. Safety gloves
- F. Safety cover of moving unit
- G. Safety shoes
- H. Working trousers



NOTICE

The tool only use before using adapted to the operator, shoulder strap. Never operate the trimmer with one hand!

11.5 Belt

- Pull the belt over your shoulders 2.
- Close the belt lock 3.
- Adjust the belt length at the belt tensioner 1 of the shoulder straps so that the machine holder 4 is at hip height.
- Adjust the belt lengths so that the machine weight is distributed evenly onto the two shoulders.
- Hook the belt with the quick coupling into the belt eyelet of the machine.

Never work without using the belt

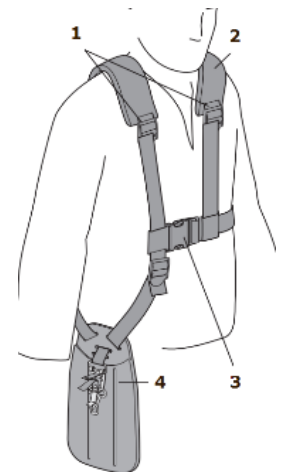



12 ASSEMBLY

Please check the product contents immediately after receipt for any eventual transport damage or missing parts. Claims from transport damage or missing parts must be placed immediately after initial machine receipt and unpacking before putting the machine into operation. Please understand that later claims cannot be accepted anymore.

12.1 Assembly

When assembling make sure that they interlock with one another. Before commissioning check all screw connections and tighten them if necessary.

12.1.1 Handle bar

- Loosen the premounted screws of the handle bar bracket and insert the handles from the side into the bracket.
- Tighten the handles to the bracket by tightening the screws.

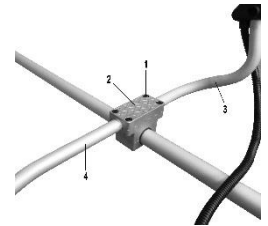

12.1.2 Safety cover

- Fix the safety cover with the mounting screws.

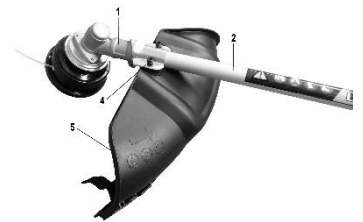

12.1.3 Nylon cutter

- Lock the gear shaft by inserting the supplied tool into the upper holder on the gear box
- Fit the nylon cutter on the thread (left thread!).

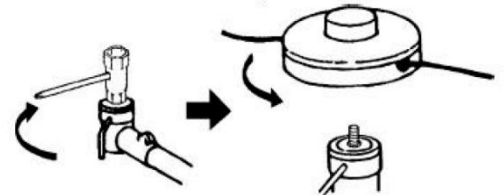

The nylon cutter is suitable for lawn or grass cuts.

12.1.4 Blade

- Lock the gear shaft by inserting the supplied tool into the upper holder on the gear box.
- Place the blade onto the gear shaft.
- Place the cover, washer and spring and fasten the blade with the nut.

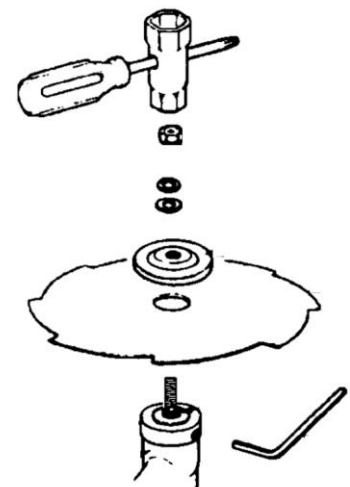

Blades are suitable for the cutting of weeds, scrub, undergrowth and tall grass.



13 OPERATION

Machine to be operated in a perfect state only. Inspect the device visually every time it is to be used. Check in particular the safety equipment, electrical controls, electric cables and screwed connection for damage and if tightened properly. Replace any damaged parts before operating the device.

13.1 Operation instructions

NOTICE

- **Shut off the machine and let it cool down before start any cleaning, upkeep, checks or maintenance!**
- **Operate the machine always with belt!**
- **In dangerous situations detach the machine with the quick release from shoulder strap**
- **Make sure the fuel and tank are in perfect condition before each start!**

13.2 Start

- Set the main switch (3) to position on „I“.
- Set Choke in position CLOSE.

HINWEIS

When the choke stands on the CLOSE position, the fuel mixture gets concentrated for starting of the cold engine. The position OPEN produces the right fuel mixture for the usual operation after starting and for starting the machine when the engine is hot.

- Push the primer pump several times until over flown fuel flows out in the clear tube.
- You find the primer between fuel tank and carburetor-bottom.
- Set the throttle lever to the start position (1►2►3)
- Grab the starting handle and start moving it slowly. At one position the resistance gets very hard. Let the cable rewind a bit and pull on it powerfully.
- If the engine is running well, set the Choke to position OPEN.



13.3 Stop

- Release the throttle lever and set the main switch (3) to position off „0“.



14 MAINTENANCE



ATTENTION

No cleaning, upkeep, checks or maintenance when machine is running

Shut off the machine and let it cool down before start servicing!

The machine does not require intense maintenance. However, to ensure a long lifespan, we strongly recommend following the upkeep and maintenance plan.

Repairs must be carried out by specialists! Use original ZIPPER parts only!

Wear safety gloves if you are work on the cutting tool!

Damaged cutting tools may never be straightened or welded!

NOTICE

Only a properly maintained equipment may be a satisfactory tool. Care and maintenance deficiencies can cause unpredictable accidents and injuries.

Repairs should be performed only by authorized service centers.

Improper operation may damage the equipment or endanger your safety.

Controls for the maintenance of the machine	
Loose or lost screws, nuts, bolts	Regularly prior to each operation
Damage of any part of the machine	Regularly prior to each operation
Damage of cutting tools	Regularly prior to each operation
Fuel tank of tightness	Regularly prior to each operation
Machine cleaning	Regularly after operation
Cleaning spark plug	Every 25 working hours
Cleaning air filter	Every 20-30 working hours

14.1 Cleaning

Clean the machine and the working attachment from soil, dust, grass, chips, and small twigs, etc. Clean the machine housing with a wet cloth and a mild detergent.

NOTE

Do not use cleaning agents or solvents; these could attack the plastic parts of the machine!

Put on all coatless flats a thin coat of oil.

14.1.1 Cleaning the air filter

The air filter has to be cleaned approx. every 20-30 working hours. This may vary depending on the air quality of your working area.

Polluted and clogged air filters reduce the engine output by far and may lead to engine damage.

To clean the air filter just remove the black air filter cover and take the filter out. Wash it in a mild water based solvent, squeeze it out, let it dry and put it back again.

14.1.2 Check the spark plug

- Clean of debris with metal brush.
- Check spark plugs match of 0.6-0.7mm

14.1.3 Carburettor

NOTE

Carburetor adjustments should be carried out only by trained specialist personnel!



14.2 Storage

If the machine will be stored longer than 30 days:

- Let the machine cool down.
- Empty Tank completely, avoid fuel spillage.
- Remove and clean thread head and cutter blade
- Fit the blade guard
- Clean the machine and dry
- Store in a dry, out of reach of children place, well packaged (protection against cuts)

14.3 Disposal

Do not dispose the machine, machine components fuel and oil in residual waste. Contact your local authorities for information regarding the available disposal options. When you buy at your local dealer for a replacement unit, the latter is obliged to exchange your old.



15 TROUBLE SHOOTING

Trouble	Possible cause	Solution
Engine does not start	• Incorrect starting sequence	• Observe the correct starting sequence
	• Dirty air filter	• Clean/replace air filter
	• No fuel supply	• Refuel
	• Fault in the fuel line	• Check the fuel line for kinks or damages
	• Engine flooded.	• Screw off, clean and dry the spark plug. Then pull the cranking rope several times and reinstall the spark plug
	• Spark plug connector not placed on.	• Place on the spark plug connector
Engine starts and is stalled immediately	• No ignition spark	• Clean/replace spark plug • Check ignition cable
	• Incorrect idle adjustment	• Contact customer service
Machine works with interruptions	• Carburetor incorrectly adjusted	• Contact customer service
	• Spark plug fouled	• Clean/replace spark plug • Check spark plug connector
Smoke	• Incorrect fuel mixture (2-stroke engine)	• Use correct fuel mixture
	• Carburetor incorrectly adjusted	• Contact customer service
Machine does not work with full performance	• Machine overloaded	• Too much pressure • Cutting material too tough
	• Dirty air filter	• Clean/replace air filter
	• Carburetor incorrectly adjusted	• Contact customer service
Blade rotates at idling	• Idle speed too high	• Adjust a lower idle speed
Blade rotates but has no power	• Choke is ON	• Set Choke to OFF
Bad cuts	• Foreign material wrapped, grass around the sheet	• Shut machine off, wait until cutter stands still, remove the winded up material
	• Long grass	• Remove material
	• Blunt saw blade	• Sharpen or replace saw blade



NOTICE

Should you in necessary repairs not able to properly to perform or you have not the prescribed training for it always attract a workshop to fix the problem.